



protect. teach. love:

**Product Manual**  
**Manuel d'utilisation**  
**Producthandleiding**  
**Manual del producto**  
**Manuale del prodotto**  
**Gebruiksaanleitung**

**PBC17-16193**

**PBC19-11796**

Little Dog Deluxe Spray Bark Control Collar

Collier anti-aboiements à jet  
de luxe pour petits chiens

Deluxe antiblaflhalsband met  
spray voor kleine honden

Collar antiladridos deluxe con  
spray para perros pequeños

Collare antiabbaio deluxe  
con spray per cani di  
piccola taglia

Deluxe Antibellhalsband  
mit Spray für  
kleine Hunde

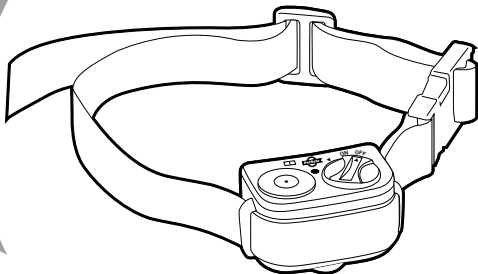

Please read this entire product manual before beginning  
Veuillez lire ce manuel d'utilisation dans son intégralité avant de commencer  
Gelieve deze producthandleiding volledig door te lezen voordat u begint  
Por favor, lea detenidamente este manual del producto antes de empezar  
Prima di iniziare, leggere per intero il manuale del prodotto  
Bitte vor Gebrauch diese Gebrauchsanleitung durchlesen

# IMPORTANT SAFETY INFORMATION

Explanation of Attention Words and Symbols used in this product manual.



This is the safety alert symbol. It is used to alert you to potential personal injury hazards. Obey all safety messages that follow this symbol to avoid possible injury or death.

## **⚠ WARNING**

WARNING indicates a hazardous situation which, if not avoided, could result in death or serious injury.

## **⚠ CAUTION**

CAUTION, used with the safety alert symbol, indicates a hazardous situation which, if not avoided, could result in minor or moderate injury.

## **CAUTION**

CAUTION, used without the safety alert symbol, indicates a hazardous situation which, if not avoided, could result in harm to your pet.

## **⚠ WARNING**

- Not for use with aggressive dogs. Do not use this product if your dog is aggressive, or if your dog is prone to aggressive behaviour. Aggressive dogs can cause severe injury and even death to their owner and others. If you are unsure whether this product is appropriate for your dog, please consult your veterinarian or certified trainer.
- Risk of explosion. Do not short circuit, mix old and new batteries, dispose of in fire, or expose to water. When batteries are stored or disposed, they must be protected from shorting. Dispose of spent batteries properly.
- Do not expose the device to freezing temperatures -32 °F or 0 °C or to conditions warmer than 113 °F or 45 °C. Do not leave the unit in direct sunlight. Never leave the unit in a car where the device can heat up to high temperatures (113 °F or 45 °C).
- Button or coin cell battery inside. Swallowed lithium batteries can cause internal chemical burns within 2 hours and can lead to death. Dispose of used batteries immediately. Keep ALL batteries away from children. If swallowed, seek immediate medical attention.



### **AEROSOLS:**

- Do not breathe dust/fume/gas/mist/vapours/spray.
- In case of inadequate ventilation, wear respiratory protection.
- If exposed or concerned: Get medical advice/attention.
- Protect from sunlight. Store in a well-ventilated place.
- Keep out of reach of children.
- **FIRST AID TREATMENT:** If inhaled, get medical attention if you feel unwell. After skin contact, rinse affected area with soap and water. After eye contact, rinse/flush eyes gently using water for 15-20 minutes.

**⚠ CAUTION**

The PetSafe® Little Dog Deluxe Spray Bark Control Collar is not a toy. Keep it away from the reach of children. Use only for its pet training purpose.

**CAUTION**

Proper fit of the collar is important. A collar worn for too long or made too tight on the pet's neck may cause skin damage ranging from redness to pressure ulcers. This condition is commonly known as bed sores.

- Avoid leaving the collar on the dog for more than 12 hours per day.
- When possible reposition the collar on the pet's neck every 1 to 2 hours.
- Check the fit to prevent excessive pressure; follow the instructions in this manual.
- Never connect a lead to the electronic collar.
- When using a separate collar for a lead, don't put pressure on the electronic collar.
- Wash the dog's neck area weekly with a damp cloth.
- Examine the neck area daily for signs of a rash or a sore.
- If a rash or sore is found, discontinue use of the collar until the skin has healed.
- If the condition persists beyond 48 hours, see your veterinarian.
- For additional information on bed sores and pressure necrosis, please visit our website.

These steps will help keep your pet safe and comfortable. You may find after some time that your pet is very tolerant of the collar. If so, you may relax some of these precautions. It is important to continue daily checks of the neck area. If redness or sores are found, discontinue use until the skin has fully healed.

The PetSafe® Little Dog Deluxe Spray Bark Control Collar must be used only on healthy dogs. We recommend that you take your dog to a veterinarian before using the Spray Collar if he is not in good health.

Thank you for choosing the PetSafe® Brand. You and your pet deserve a companionship that includes memorable moments and a shared understanding together. Our products and training tools enhance the relationship between pets and their owners. If you have any questions about our products or training your pet, please visit our website at [petsafe.com](https://petsafe.com) or contact our Customer Care Centre. For a listing of Customer Care Centre telephone numbers, visit our website at [petsafe.com](https://petsafe.com).

To get the most protection out of your warranty, please register your product within 30 days at [petsafe.com](https://petsafe.com). By registering and keeping your receipt, you will enjoy the product's full warranty and should you ever need to call the Customer Care Centre, we will be able to help you faster. Most importantly, your valuable information will never be given or sold to anyone. Complete warranty information is available online at [petsafe.com](https://petsafe.com).

---

## Table of Contents

Components . . . . .	5
Features . . . . .	5
How the System Works . . . . .	5
Key Definitions . . . . .	6
Fit the Spray Collar . . . . .	6
Ensure a Proper Spray Pattern . . . . .	7
On/Off Battery Module . . . . .	7
To Insert and Remove the Battery . . . . .	7
To Fill and Refill the Unscented Spray . . . . .	8
Testing the Spray Collar . . . . .	9
What to Expect During Use of Spray Collar . . . . .	9
Tips and Maintenance . . . . .	10
Accessories . . . . .	11
Frequently Asked Questions . . . . .	11
Troubleshooting . . . . .	12
Terms of Use and Limitation of Liability . . . . .	13
Battery Disposal . . . . .	13
Important Recycling Advice . . . . .	13
Compliance . . . . .	14
Warranty . . . . .	14

# Components

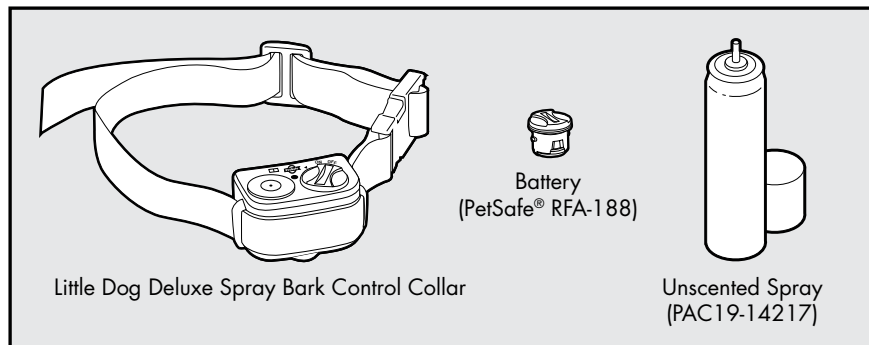

## Features

- Custom designed for small dogs up to 26 kg
- Adjustable nylon collar for neck sizes up to 50 cm with the QuickFit™ Buckle
- All-natural Unscented spray is safe and effective
- Waterproof
- Good/Low battery indicator
- 30-40 sprays per refill
- Low spray indicator

## How the System Works

The PetSafe® Little Dog Deluxe Spray Bark Control Collar effectively deters barking when it is worn. The Spray Collar has a unique sensor that provides the most reliable bark detection available. The Spray Collar uses both vibration and sound sensors (Dual Detection) to discriminate each bark from other external noises. A burst of Unscented spray is emitted to deter barking only if both the vibration from vocal chords and the sound from the bark match the same criteria.

# Key Definitions

**Spray Nozzle:** Where the spray ejects when your dog's bark is detected.

**Sound Activated Sensor:** Detects the sound of your dog's bark.

**Refill Port:** Where the spray is refilled.

**Yellow LED:** Low spray indicator.

**Two Colour LED:** Shows good or low battery.

**On/Off Battery Module:** Turns the Spray Collar on and off, and resets the spray counter.

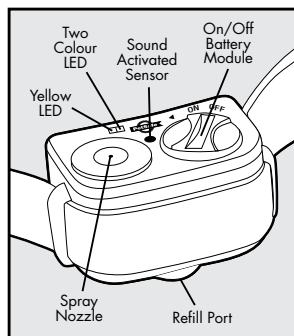

## Fit the Spray Collar

**Important:** The proper fit and placement of your Spray Collar is important for effective operation. To assure a proper fit, please follow these steps:

1. Make sure that the Spray Collar is turned off.
2. Start with your dog standing comfortably (A).
3. Place the Spray Collar high on your dog's neck close to the ears. Centre the unit underneath your dog's neck with the spray nozzle facing upward (B).
4. Check the tightness of the Spray Collar by inserting one finger between the collar and the back of the dog's neck. The fit should be snug but not constricting (C).
5. Allow your dog to wear the Spray Collar for several minutes, then recheck the fit. Check the fit again as your dog becomes more comfortable with it.
6. Trim the Spray Collar as follows (D):
  - a. Mark the desired length with a pen. Allow for growth if your dog is young or grows a thick winter coat.
  - b. Remove the Spray Collar from your dog and cut off excess.
  - c. Before placing the Spray Collar back onto your dog, seal the edge of the cut collar by applying a flame along the frayed edge.
7. The PetSafe® QuickFit™ collar is designed so you can quickly attach and remove the Spray Collar from your dog while maintaining the desired fit. Once the fit is determined, simply use the Snap Buckle to remove and replace the Spray Collar.

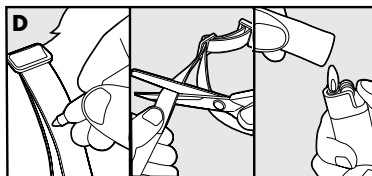
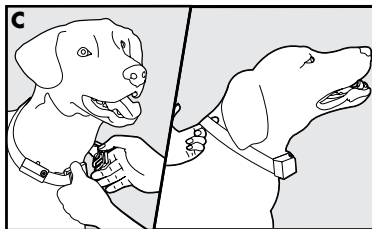
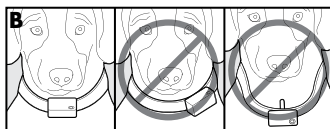
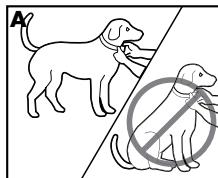

## To Re-Thread the Collar

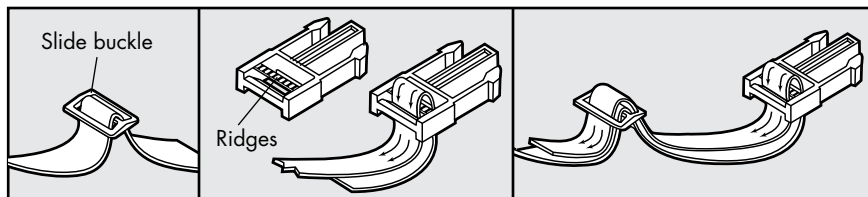

- The slide buckle prevents the collar from becoming loose around your pet's neck.
- The ridges must be facing up; the collar will slip if it is not properly threaded.

## Ensure a Proper Spray Pattern

For the Spray Collar to perform properly, the nozzle must be positioned correctly and there must be a clear path from the Spray Nozzle to your dog's snout. Follow these steps:

1. Make sure the PetSafe® logo on the top of the unit is facing upward and the Spray Nozzle is angled out and pointing up towards the dog's snout.
2. For long-haired dogs, it may be necessary to trim the neck hairs along the path of the spray. It is important that the spray reaches the dog's snout to be effective.

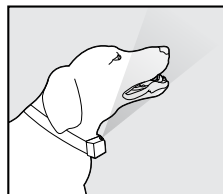

## On/Off Battery Module

The Spray Collar is packaged with the battery module installed in the OFF position. To turn on the Spray Collar, use a coin to turn the battery module counter clockwise until the line on the battery lines up with the ON position (E) and the green LED begins blinking. It is very important that the line on the battery lines up precisely with the ON position to ensure that the Spray Collar is working. If the Spray Collar is not going to be used on the dog immediately, leave the battery module in the OFF position.

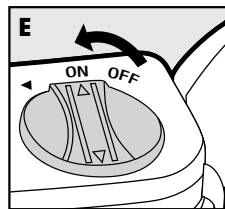

## To Insert and Remove the Battery

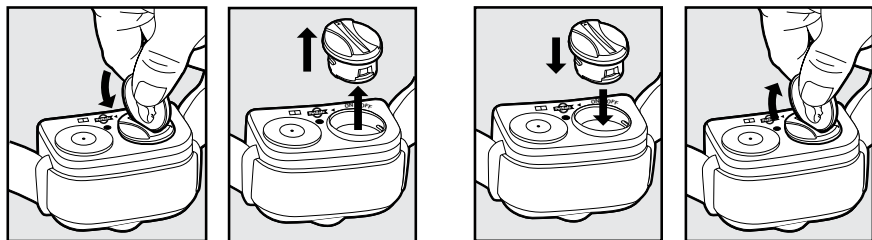

- To replace the battery, use a coin to twist the battery counter clockwise all the way until the line on the battery lines up with the arrow head symbol▼ on the Spray Collar. Remove the old battery.
- To insert a new battery, align the line on the battery with the arrow head symbol▼ on the Spray Collar, then insert the battery into the Spray Collar. Use a coin to press down and twist the battery clockwise to the ON or OFF position.

Note: Do not install the battery while the Spray Collar is on your dog.

A replacement PetSafe® battery (RFA-188) can be found at many retailers. Contact the Customer Care Centre or visit our web site at [petsafe.com](http://petsafe.com) to locate a retailer near you.

## Battery Life

Average battery life is 2 to 4 months, depending on how often your dog barks. However, due to greater use during your dog's training, your first battery may not last as long as replacement batteries.

## Function and Response Table

Function	LED Light Response
Unit is on	Green LED Light flashes once every 5 seconds
Low battery condition	Red LED Light flashes 3 times every 5 seconds
Low spray warning	Yellow LED Light appears

## To Fill and Refill the Unscented Spray

- Remove the Spray Collar from your dog.
- Turn the Spray Collar off.
- Ensure that the Refill Port is clean.  
*Note: If any dirt or debris enters the Refill Port when refilling, it could cause the unit to become clogged and malfunction. Please read the "Tips and Maintenance" section for proper care.*
- Hold the Unscented spray can upright and firmly press the nozzle down into the Refill Port. Hold for 15 seconds and remove. *Note: If spray leaks out, you may need to press harder to complete the seal.*
- Turn the Spray Collar on.

For optimal performance the Spray Collar should be refilled before each use.

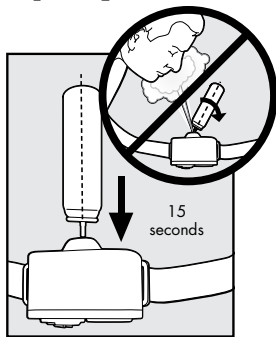

### ⚠ WARNING

Do not puncture or incinerate the Spray Collar or the refill canister.  
Do not expose to extreme heat or store at temperatures above 50°C.



**Resetting the Spray Counter** (recommended after each refill):

1. After refilling the spray, turn the Spray Collar on.
2. The Spray Collar LED will turn green for 1 second,
3. Next the LED will turn yellow for 2 seconds.
4. As soon as the yellow LED disappears, turn the Spray Collar off.

*NOTE: You must wait until the yellow LED disappears before turning the battery to the off position. If you turn the Spray Collar off too quickly (prior to the yellow LED disappearing) the Spray Collar will continually blink yellow indicating that it is in the test mode.*

5. Wait 2 seconds.
6. Turn the Spray Collar on.

---

## Testing the Spray Collar

**NOTE:** Keep the Spray Collar away from your face during testing.

1. Turn the Spray Collar on.
2. The Spray Collar LED will turn solid green for 1 second.
3. Next the LED will turn solid yellow for 2 seconds.
4. As soon as the LED is yellow, turn the Spray Collar back to the OFF position.
5. Wait 2 seconds with the Spray Collar off.
6. Then turn the Spray Collar back on again.
7. The LED will flash yellow to indicate that the Spray Collar is in test mode.
8. During the flashing of the yellow LED, rub the Spray Collar with a coin to create a vibration. After it has sprayed, it will have a time-out of about 10-15 seconds before it can be tested again. After approximately 1 minute the LED flashes green to indicate the Spray Collar is now in normal operation again.

Refill canisters are available. Choose from citronella or Unscented spray. Contact the Customer Care Centre or visit our web site at [petsafe.com](http://petsafe.com) to locate a retailer near you.

---

## What to Expect During Use of Spray Collar

**Important: Do not leave your dog alone the first few times he wears the Spray Collar.**

Place the Spray Collar properly on your dog and wait nearby until he barks. Most dogs will understand very quickly that the Spray Collar is disrupting their urge to bark and will relax and stop barking. Because the burst of Unscented spray from the Spray Collar may be surprising or startling at first, some dogs may bark more at the initial correction.

On rare occasions, a dog may get into a bark-spray-bark-spray cycle. If this happens, reassure your dog with calm, soothing tones. As your dog relaxes, he will understand that if he becomes quiet, he will not receive any more spray bursts. The small minority of dogs that have this reaction should only have it the first time they wear the Spray Collar.

You should notice a reduction in your dog's barking within the first couple of days that he wears the Spray Collar. At this point, it is important to remember the learning process is still not complete. Dogs will "test" this new learning experience and will increase their attempts to bark. This usually occurs during the second week a dog wears the Spray Collar. If this does occur, remain consistent and do not alter your use of the Spray Collar. You must place the Spray Collar on your dog in

every situation when you expect him to be quiet. If your dog is not wearing the Spray Collar, he may resume barking and his learning would suffer a setback.

## Tips and Maintenance

- Before playing with your dog, turn the Spray Collar off and remove it from your dog. The activity may cause your dog to bark, which could lead to him associating the play with the burst of spray.
- The Spray Collar must be filled to maximum capacity before placing it around your dog's neck.
- Never fill the Spray Collar while your dog is wearing it because it may damage the Refill Port.
- To ensure that your dog does not make the connection between you and the Spray Collar, don't let him see you prepare the Spray Collar for the first try, or for subsequent use. Keep your dog away while you prepare the Spray Collar as well as when you fill it or change the battery.
- Avoid letting your dog wear the Spray Collar with an empty reservoir. Make sure it is always full.
- Turn OFF the Spray Collar while not in use.
- The Spray Collar should only be used with pets that are over 6 months of age.
- If your pet is injured or its mobility is otherwise impaired, contact your veterinarian or professional trainer before use.
- Do not leave your Spray Collar unattended where your dog could accidentally damage it through chewing.
- Never fill the Spray Collar with any substance other than the one provided by the manufacturer. Using another substance, as well as opening the device, will void the manufacturer's warranty.
- Do not attempt to repair the device yourself. This will invalidate the warranty and make repairs more difficult.
- The spray from the Spray Collar may stick to the hair under your dog's snout. Clean your dog's hair weekly with a washcloth and a mild hand soap. Rinse and dry your dog's neck thoroughly.
- If spray, dirt, or debris accumulates on the Spray Collar (including the nozzle and refill port), wipe the Spray Collar clean with a damp cloth and dry thoroughly. It is recommended that the unit be cleaned monthly or as needed to prevent clogging. The need for cleaning will depend on usage.

## Accessories

To purchase additional accessories for your PetSafe® Little Dog Deluxe Spray Bark Control Collar, visit our website at [petsafe.com](http://petsafe.com) to locate a retailer near you and for a listing of Customer Care Centre telephone numbers in your area.

### Frequently Asked Questions

<b>Will another dog's bark set off the Spray Collar?</b>	<ul style="list-style-type: none"><li>No.</li></ul>
<b>Is the Spray Collar safe and humane?</b>	<ul style="list-style-type: none"><li>Yes. The Spray Collar is designed to get your dog's attention, not to punish him.</li></ul>
<b>Will the Spray Collar work for my dog?</b>	<ul style="list-style-type: none"><li>The Spray Collar is safe and effective for all breeds and sizes of dogs, however, it is recommended for little dogs.</li></ul>
<b>Is the spray harmful?</b>	<ul style="list-style-type: none"><li>This unit uses an Unscented spray that dogs find unpleasant. It dissipates quickly and is safe for humans and pets.</li></ul>
<b>Will this work with long-haired dogs?</b>	<ul style="list-style-type: none"><li>Yes. It may be necessary to trim the hair on your dog's neck so it does not block the spray from reaching his snout.</li></ul>
<b>Does the spray need to hit my dog's nose?</b>	<ul style="list-style-type: none"><li>No. The spray is very fine and simply creates a mist in the region of the snout.</li></ul>
<b>Can I attach a lead to the Spray Collar?</b>	<ul style="list-style-type: none"><li>Do not attach a lead to the Spray Collar. You may put a separate non-metallic collar or harness on your dog's neck and attach a lead and/or tags. <i>Note: Be sure the extra collar does not interfere with the path of the spray.</i></li></ul>

## Troubleshooting

<b>The Spray Collar does not spray.</b>	<ul style="list-style-type: none"><li>• Ensure that the battery is properly installed.</li><li>• Replace the battery.</li><li>• Ensure unit is on.</li><li>• Ensure the Spray Nozzle is not clogged. <i>Note: See "Tips and Maintenance" section.</i></li><li>• Refill the unit with the Unscented spray.</li><li>• Follow the testing instructions listed in the guide.</li><li>• If the Spray Collar still does not spray, contact the Customer Care Centre.</li></ul>
<b>My Spray Collar sprays, but my dog keeps barking (does not respond to the burst of spray).</b>	<ul style="list-style-type: none"><li>• Tighten the Spray Collar.</li><li>• Check to make sure the Spray Nozzle points towards the dog's snout.</li><li>• Make sure your dog's hair does not block the spray. If so, trim the hair so the spray can reach the snout area.</li><li>• If your dog still does not respond, contact the Customer Care Centre.</li></ul>
<b>When I try to refill the unit with the Unscented spray, the spray leaks out around the Spray Nozzle.</b>	<ul style="list-style-type: none"><li>• Hold the Unscented spray can upright. If it is held at an angle, it will not create a good seal.</li><li>• Press firmly on the Unscented spray can to create a good seal.</li><li>• If the spray continues to leak, contact the Customer Care Centre.</li></ul>
<b>I have refilled the Spray Collar and the yellow LED continues to flash.</b>	<ul style="list-style-type: none"><li>• Ensure the spray counter has been reset. <i>Note: See "To Fill and Refill the Spray" section.</i></li><li>• If the yellow LED continues to flash after the spray counter has been reset, contact the Customer Care Centre.</li></ul>

# Terms of Use and Limitation of Liability

- 1. Terms of Use:** The use of this product is subject to your acceptance without modification of the terms, conditions and notices contained with this product. Use of this product implies acceptance of all such terms, conditions, and notices. If you do not wish to accept these terms, conditions, and notices, please return the product, unused, in its original packaging and at your own cost and risk to the relevant Customer Care location together with proof of purchase for a full refund.
- 2. Proper Use:** Proper Use includes, without limitation, reviewing the entire product manual and any specific safety information statements. The specific temperament or size/weight of your pet may not be suitable for this product. If you are unsure whether this product is appropriate for your pet, please consult your veterinarian or certified trainer prior to use. For products used with pets where training is desired, Radio Systems Corporation recommends that these training products are not used if your pet is aggressive and accepts no liability for determining suitability in individual cases.
- 3. No Unlawful or Prohibited Use:** This product is designed for use with pets only. This device is not intended to harm, injure, or provoke. Using this product in a way that is not intended could result in violation of Federal, State or local laws.
- 4. Limitation of Liability:** In no event shall Radio Systems Corporation or any of its associated companies be liable for (i) any direct, indirect, punitive, incidental, special or consequential damage and/or (ii) any loss or damages whatsoever arising out of or connected with the use or misuse of this product. The Purchaser assumes all risks and liability from the use of this product to the fullest extent permissible by law.
- 5. Modification of Terms and Conditions:** Radio Systems Corporation reserves the right to change the terms, conditions and notices governing this product from time to time. If such changes have been notified to you prior to your use of this product, they shall be binding on you as if incorporated herein.



## Battery Disposal

Separate collection of spent batteries is required in many regions. Check the regulations in your area before discarding spent batteries. At the end of the product life, please contact our Customer Care Centre to receive instructions on proper disposal of the unit. Please do not dispose of the unit in household or municipal waste. For a listing of Customer Care Centre telephone numbers in your area, visit our website at [www.petsafe.com](http://www.petsafe.com).



## Important Recycling Advice

Please respect the Waste Electrical and Electronic Equipment regulations in your country. This equipment must be recycled. At the end of the product life, do not place it in the normal municipal waste system. Please check the regulations in your area or return it to where it was purchased so that it can be placed in our recycling system. If these options are not possible, please contact the Customer Care Centre for further information.

# Compliance



Radio Systems Corporation declares under its own responsibility, that the following product is in compliance with the essential requirements under the EMC Directive 2014/30/EU, and the RoHS 2 Directive (EU) 2015/863. Unauthorised changes or modifications to the equipment that are not approved by Radio Systems Corporation may violate EU EMC regulations, could void the user's authority to operate the equipment, and will void the warranty. Hereby, Radio Systems Corporation, declares that this product is in compliance with the essential requirements and other relevant provisions. The Declaration of Conformity can be found at [www.petsafe.com/customer-care/eu\\_docs.php](http://www.petsafe.com/customer-care/eu_docs.php).

## IC

This device complies with Industry Canada licence-exempt RSS standard(s). Operation is subject to the following two conditions: (1) this device may not cause interference, and (2) this device must accept any interference, including interference that may cause undesired operation of the device.

## ACMA

This device complies with the applicable EMC requirements specified by the ACMA (Australian Communications and Media Authority).

---

# Warranty

## Three Year Non-Transferable Limited Warranty

This product has the benefit of a limited three-year manufacturer's warranty. Complete details of the warranty applicable to this product and its terms can be found on-line and/or are available by contacting your local Customer Care Centre.

### Europe

Radio Systems PetSafe Europe Ltd.  
2nd Floor, Elgee Building, Market Square  
Dundalk, Co. Louth, A91 YR9X Ireland

### Canada

Radio Systems Corporation  
10427 PetSafe Way  
Knoxville, TN 37932 USA

**Australia/New Zealand** – In compliance with the Australian Consumer Law, Warranties Against Defects, effective January 1, 2012, warranty details of this Product are as follows: Radio Systems Australia Pty Ltd. (hereinafter referred to as "Radio Systems") warrants to the original retail purchaser, and not any other purchaser or subsequent owner, that its Product, when subject to normal and proper residential use, will be free from defects in material or workmanship for a period of three (3) years from the purchase date. An "original retail consumer purchaser" is a person or entity who originally purchases the Product, or a gift recipient of a new Product that is unopened and in its original packaging. When serviced by Radio Systems Customer Service, Radio Systems covers labour and parts for the first three years of ownership; after the first three years, a service or upgrade charge will apply relative to replacement of the Product with new or refurbished items at Radio Systems' sole discretion.

The limited warranty is non-transferable and shall automatically terminate if the original retail consumer purchaser resells the Radio Systems Product or transfers the property on which the Radio Systems Product is installed. This Limited Warranty excludes accidental damage due to pet chews; lightning damage; or neglect, alteration, and misuse. Consumers who purchase products outside of Australia, New Zealand, or from an unauthorised dealer will need to return the Product to the original place of purchase for any warranty issues.

Please note that Radio Systems does not provide refunds, replacements, or upgrades for change of mind, or for any other reason outside of these Warranty terms.

Claims Procedure: Any claim made under this Warranty should be made directly to Radio Systems Australia Pty Ltd. Customer Care Centre at:

Radio Systems Australia Pty Ltd.  
PO Box 3442, Australia Fair  
QLD 4215, Australia

Australia Residents: 1800 786 608  
New Zealand Residents: 0800 543 054  
Email: [aus-info@petsafe.net](mailto:aus-info@petsafe.net)

To file a claim, a proof of purchase must be provided. Without a proof of purchase, Radio Systems will not repair or replace faulty components. Radio Systems requests the Consumer to contact the Radio Systems Customer Care Centre to obtain a Warranty Return number, prior to sending the Product. Failure to do so may delay in the repair or replacement of the Product.

If the Product is deemed to be faulty within 30 days from date of original purchase, Radio Systems will organise for a replacement to be sent in advance of returning the faulty Product. A Post Bag will be included with the replacement Product for the return of the faulty Product. The Product must be returned within 7 days of receiving the replacement. If the Product is deemed to be faulty after 30 days from the date of original purchase, the consumer will be required to return the Product to Radio Systems at the consumer's own expense. Radio Systems will test and replace the faulty unit or its components and return to the consumer free of charge, provided the Product is within its said warranty period. This warranty is in addition to other rights and remedies available to you under the law. Radio Systems goods come with guarantees that cannot be excluded under the Australia Consumer Law. You are entitled to a replacement or refund for a major failure and for compensation for any other reasonably foreseeable loss or damage. You are also entitled to have the goods repaired or replaced if the goods fail to be of acceptable quality and the failure does not amount to a major failure.

Should you have any queries or require any further information, please contact our Customer Care Centre on 1800 786 608 (Australia) or 0800 543 054 (New Zealand).

PetSafe® products are designed to enhance the relationship between you and your pet. To learn more about our extensive product range which includes Containment Systems, Training Systems, Bark Control, Pet Doors, Health & Wellness, Waste Management and Play & Challenge products, please visit [petsafe.com](http://petsafe.com).

Les produits PetSafe® sont conçus pour améliorer la relation entre vous et votre animal de compagnie. Pour en savoir plus sur notre vaste gamme de produits, comprenant des systèmes de confinement, de dressage, de contrôle de l'aboiement, des chatières, des produits consacrés à la santé et au bien-être, de gestion des déjections, ainsi qu'au jeu et aux défis, rendez-vous sur notre site [petsafe.com](http://petsafe.com).

PetSafe® producten zijn ontworpen om de relatie tussen u en uw huisdier te verbeteren. Bezoek onze website op [petsafe.com](http://petsafe.com) voor meer informatie over onze uitgebreide productreeks die onder meer omheiningssystemen, trainingssystemen, blafbeheersing, kattenluiken, gezondheid en welzijn, afvalbeheersing en producten voor spel en uitdaging omvat.

Los productos PetSafe® están diseñados para mejorar la relación entre usted y su mascota. Para saber más acerca de nuestra amplia gama de productos, que incluyen limitadores de zona, sistemas de adiestramiento, control de ladridos, puertas para mascotas, salud y bienestar, gestión de residuos y productos de juego y reto, visite [petsafe.com](http://petsafe.com).

I prodotti PetSafe® sono progettati per migliorare la qualità della relazione tra voi e il vostro cane. Per ulteriori informazioni sulla nostra estesa gamma di prodotti comprendente sistemi antifuga, soluzioni per l'addestramento, controllo dell'abbaiamento, porte per animali domestici, i prodotti della linea salute e benessere, gestione dei rifiuti e gioco e prova, visitare: [petsafe.com](http://petsafe.com).

PetSafe® Produkte sind darauf ausgelegt, die Beziehung zwischen Ihnen und Ihrem Haustier zu verbessern. Um mehr über unsere breite Produktpalette zu erfahren, die Rückhaltesysteme, Trainingssysteme, Bellkontrolle, Haustiertüren, Gesundheit & Wellness, Haustiertoiletten und Sport und Spiel umfasst, besuchen Sie bitte uns auf [petsafe.com](http://petsafe.com).

Radio Systems Corporation  
10427 PetSafe Way  
Knoxville, TN 37932  
+1 (865) 777-5404

Radio Systems PetSafe Europe Ltd.  
2nd Floor, Elgee Building, Market Square  
Dundalk, Co. Louth, A91 YR9X Ireland  
+353 (0) 42 942 4122

Radio Systems Australia Pty Ltd.  
Suite 11001 Australia Fair Office Towers  
36 Marine Parade, Southport, QLD 4215, Australia  
+61 1800 786 608



[petsafe.com](http://petsafe.com)

J400-1027-31/4  
©2021 Radio Systems Corporation