



protect. teach. love.®

Elite Little Dog Spray Bark Control

operating guide

Model Number
PBC00-11283

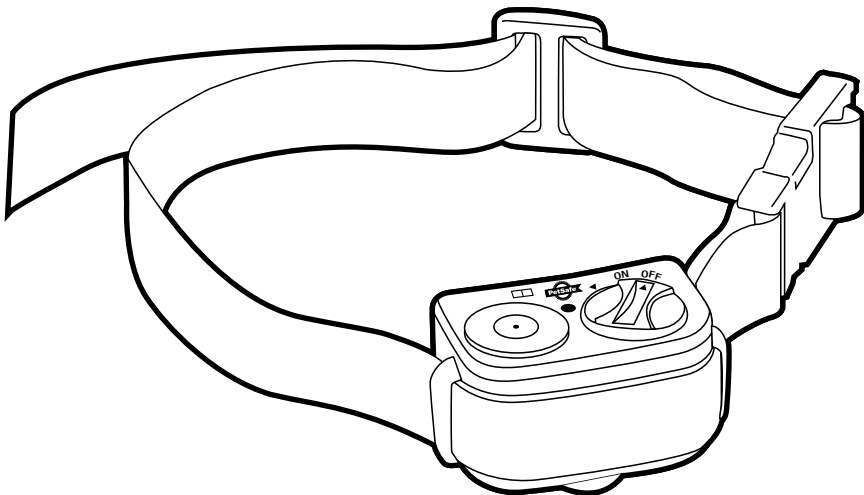

PLEASE READ THIS ENTIRE GUIDE BEFORE BEGINNING

Important Safety Information

Explanation of Attention Words and Symbols used in this guide



This is the safety alert symbol. It is used to alert you to potential personal injury hazards. Obey all safety messages that follow this symbol to avoid possible injury or death.

⚠ WARNING

WARNING indicates a hazardous situation which, if not avoided, could result in death or serious injury.

⚠ CAUTION

CAUTION, used with the safety alert symbol, indicates a hazardous situation which, if not avoided, could result in minor or moderate injury.

CAUTION

CAUTION, used without the safety alert symbol, indicates a hazardous situation which, if not avoided, could result in harm to your pet.

⚠ WARNING

- Not for use with aggressive dogs. Do not use this Product if your dog is aggressive, or if your dog is prone to aggressive behavior. Aggressive dogs can cause severe injury and even death to their owner and others. If you are unsure whether this product is appropriate for your dog, please consult your veterinarian or certified trainer.
- Risk of explosion. Do not short circuit, mix old and new batteries, dispose of in fire, or expose to water. When batteries are stored or disposed, they must be protected from shorting. Dispose of used batteries properly.
- Do not expose the device to freezing temperatures (-32°F or 0°C) or to conditions warmer than 113°F or 45°C. Do not leave the unit in direct sunlight. Never leave the unit in a car where the device can heat up to high temperatures (113°F or 45°C).
- Button or coin cell battery inside. Swallowed lithium batteries can cause internal chemical burns within 2 hours and can lead to death. Dispose of used batteries immediately. Keep ALL batteries away from children. If swallowed, seek immediate medical attention.



AEROSOLS:

- Do not inhale dust/fume/gas/mist/vapors/spray.
- In case of inadequate ventilation, wear respiratory protection.
- If exposed or concerned, get medical advice/attention.
- Protect from sunlight. Store in a well-ventilated place.
- Keep out of reach of children.
- FIRST AID TREATMENT: If inhaled, get medical attention if you feel unwell. After skin contact, rinse affected area with soap and water. After eye contact, rinse/flush eyes gently using water for 15-20 minutes.

⚠ CAUTION

- The PetSafe® Elite Little Dog Spray Bark Control Collar is not a toy. Keep it away from the reach of children. Use it only for its bark stopping purpose.

CAUTION

Risk of skin damage. Please read and follow the instructions in this manual. Proper fit of the collar is important. A collar worn for too long or made too tight on the pet's neck may cause skin damage ranging from redness to pressure ulcers. This condition is commonly known as bed sores.

- Avoid leaving the collar on the dog for more than 12 hours per day.
- When possible reposition the collar on the pet's neck every 1 to 2 hours.
- Check the fit to prevent excessive pressure; follow the instructions in this manual.
- Never connect a lead to the electronic collar.
- When using a separate collar for a lead, don't put pressure on the electronic collar.
- Wash the dog's neck area weekly with a damp cloth.
- Examine the neck area daily for signs of a rash or a sore.
- If a rash or sore is found, discontinue use of the collar until the skin has healed.
- If the condition persists beyond 48 hours, see your veterinarian.
- For additional information on bed sores and pressure necrosis, please visit our website.

These steps will help keep your pet safe and comfortable. You may find after some time that your pet is very tolerant of the collar. If so, you may relax some of these precautions. It is important to continue daily checks of the neck area. If redness or sores are found, discontinue use until the skin has fully healed.

The PetSafe® Elite Little Dog Spray Bark Control Collar must be used only on healthy dogs. We recommend that you take your dog to a veterinarian before using the Spray Collar if he is not in good health.

Thank you for choosing the PetSafe® brand. You and your pet deserve a companionship that includes memorable moments and a shared understanding together. Our products and training tools promote a lifestyle of protection, teaching, and love—essentials that influence memories for a lifetime. If you have any questions about our products or training your pet, please visit our website at petsafe.com or contact our Customer Care Center at +1 (800) 732-2677.

To get the most protection out of your warranty, please register your product within 30 days at petsafe.com. By registering and keeping your receipt, you will enjoy the product's full warranty and should you ever need to call the Customer Care Center, we will be able to help you faster. Most importantly, PetSafe® will never give or sell your valuable information to anyone. Complete warranty information is available online at petsafe.com.

Table of Contents

Components.....	5
Features.....	5
How the Elite Little Dog Spray Bark Control Collar Works.....	5
Key Definitions	6
Fit the Spray Collar.....	6
On/Off Battery Module	7
To Fill and Refill the Spray Collar.....	9
Testing the Spray Collar	9
What to Expect During Use of the Spray Collar.....	10
Tips and Maintenance	10
Frequently Asked Questions	11
Troubleshooting	11
Customer Care International	12
Terms of Use and Limitation of Liability	12
Battery Disposal	13
Important Recycling Advice	13
Perchlorate Battery.....	13
FCC	14
Warranty	14

Components

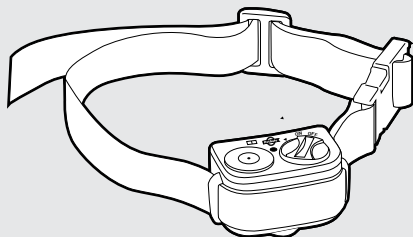

**PetSafe® Elite Little Dog
Spray Bark Control Collar**



**Battery
(PetSafe® RFA-188)**

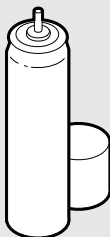

**Citronella Spray
PAC17-16190**

Features

- Patented Perfect Bark™ technology ensures your dog's bark is the only sound that will cause the correction Custom designed for small dogs up to 55 pounds
- Adjustable nylon collar for neck sizes up to 20"
- Waterproof
- Good/Low battery indicator
- 30-40 sprays per refill
- Low spray indicator

How the Elite Little Dog Spray Bark Control Collar Works

The PetSafe® Elite Little Dog Spray Bark Control Collar effectively deters barking when it is worn. The Spray Collar has a unique sensor that provides the most reliable bark detection available. The Spray Collar uses both vibration and sound sensors (Dual Detection) to discriminate each bark from other external noises. A burst of spray is emitted to deter barking only if both the vibration from vocal chords and the sound from the bark match the same criteria.

Key Definitions

Spray Nozzle: Where the spray ejects when your dog's bark is detected.

Sound Activated Sensor: Detects the sound of your dog's bark.

Refill Port: Where the spray is refilled.

Yellow LED: Low spray indicator.

Two Color LED: Shows good or low battery.

On/Off Button: Turns the Spray Collar on and off, and resets the spray counter.

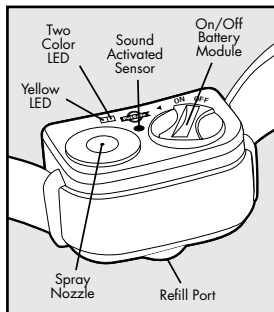

Fit the Spray Collar

Important: The proper fit and placement of your Spray Collar is important for effective operation.

To assure a proper fit, please follow these steps:

1. Make sure that the Spray Collar is turned off.
2. Start with your dog standing comfortably (A).
3. Place the Spray Collar on your dog's neck close to the ears. Center the unit underneath your dog's neck with the spray nozzle facing upward (B).
4. Check the tightness of the Spray Collar by inserting one finger between the Spray Collar and the back of the dog's neck (C). The fit should be snug but not constricting.
5. Allow your dog to wear the Spray Collar for several minutes, then recheck the fit. Check the fit again as your dog becomes more comfortable with the Spray Collar.
6. Trim the Spray Collar as follows: (D)
 - a. Mark the desired length of the Spray Collar with a pen. Allow for growth if your dog is young or grows a thick winter coat.
 - b. Remove the Spray Collar from your dog and cut off excess.
 - c. Before placing the Spray Collar back onto your dog, seal the edge of the cut collar by applying a flame along the frayed edge.
7. The PetSafe® QuickFit™ collar is designed so you can quickly attach and remove the Spray Collar from your dog while maintaining the desired fit. Once the fit is determined, simply use the Snap Buckle to remove and replace the Spray Collar.

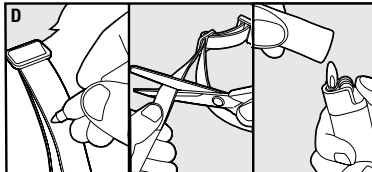
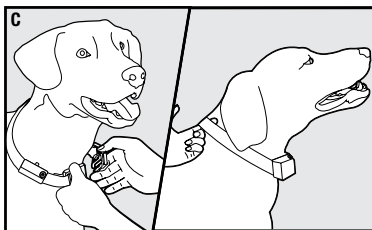
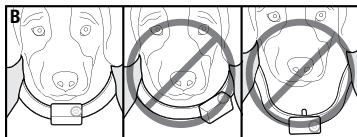
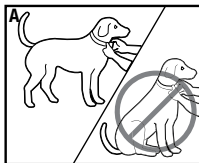

CAUTION

The Spray Collar should not be worn for more than 12 hours out of every 24-hour period. Leaving the Spray Collar on too long could lead to skin irritation. Please refer to page 2 for additional information.

To Re-Thread the Spray Collar

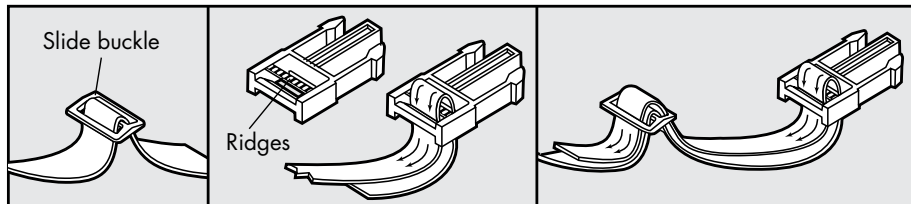

- The slide buckle prevents the Spray Collar from becoming loose around your pet's neck.
- The ridges must be facing up; the Spray Collar will slip if it is not properly threaded.

Ensure a Proper Spray Pattern

For the Spray Collar to perform properly, the nozzle must be positioned correctly and there must be a clear path from the Spray Nozzle to your dog's snout. Follow these steps:

1. Make sure the PetSafe® logo on the front of the unit is upright and the Spray Nozzle is angled out and pointing up towards the dog's snout.
2. For long-haired dogs, it may be necessary to trim the neck hairs along the path of the spray. It is important that the spray reaches the dog's snout to be effective.

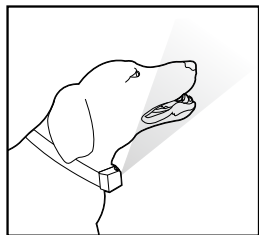

CAUTION

Do not shave the pet's neck as this may increase the risk of skin irritation.

On/Off Battery Module

The Elite Little Dog Spray Bark Control Collar is packaged with the battery module installed in the **OFF** position. To turn on the Spray Collar, use a coin to turn the Battery Module counter clockwise until the line on the battery lines up with the **ON** position (**E**) and the green LED begins blinking. It is very important that the line on the battery lines up precisely with the **ON** position to ensure that the Spray Collar is working. If the Spray Collar is not going to be used on the dog immediately, leave the battery module in the **OFF** position.

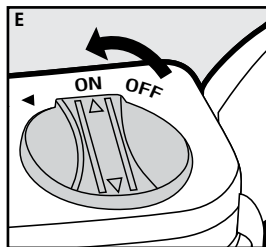

To Insert and Remove the Battery

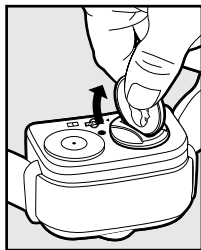
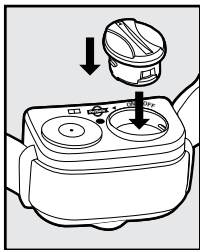
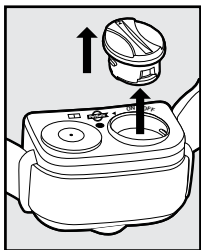
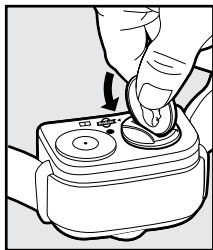

- To replace the battery, use a coin to twist the battery counter clockwise all the way until the line on the battery lines up with the arrow head symbol ▼ on the Spray Collar. Remove the old battery.
- To insert a new battery, align the line on the battery with the arrow head symbol ▼ on the Spray Collar, then insert the battery into the Spray Collar. Use a coin to press down and twist the battery clockwise to the ON or OFF position.

Note: Do not install the battery while the Elite Little Dog Spray Bark Control Collar is on your dog.

A replacement PetSafe® battery (RFA-188) can be found at many retailers. Contact the Customer Care Center or visit our web site at petsafe.com to locate a retailer near you.

Battery Life

Average battery life is 2 to 4 months, depending on how often your dog barks. However, due to greater use during your dog's training, your first battery may not last as long as replacement batteries.

⚠ WARNING

Do not attempt to cut into or pry open the battery. Be sure to discard the used battery properly.

Function and Response Table

Function	LED Light Response
Unit is on	Green LED Light flashes once every 5 seconds
Low battery condition	Red LED Light flashes 3 times every 5 seconds
Low spray warning	Yellow LED Light appears

To Fill and Refill the Spray Collar

- Remove the Spray Collar from your dog.
- Turn the Spray Collar off.
- Ensure the refill port is clean. *Note: If any dirt or debris enters the refill port when refilling, it could cause the unit to become clogged and malfunction. Please read the "Tips and Maintenance" section for proper care.*
- Hold the spray can upright and firmly press the nozzle down into the Refill Port. Hold for 15 seconds and remove. *Note: If spray leaks out, you may need to press harder to complete the seal.*
- Turn the Spray Collar on.
- For optimal performance, the Spray Collar should be refilled before each use.

Resetting the Spray Counter (recommended after each refill):

1. After refilling the spray, turn the Spray Collar on.
2. The Spray Collar LED will turn green for 1 second.
3. Next the LED will turn yellow for 2 seconds.
4. As soon as the yellow LED disappears, turn the Spray Collar off.

NOTE: You must wait until the yellow LED disappears before turning the battery to the OFF position. If you turn the Spray Collar off too quickly (prior to the yellow LED disappearing), the Spray Collar will continually blink yellow indicating it is in the test mode.

5. Wait 2 seconds.
6. Turn the Spray Collar on.

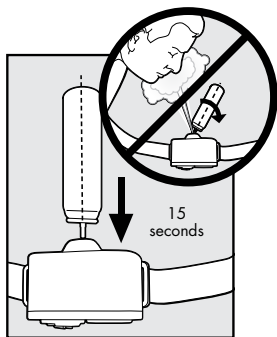

CAUTION

Do not puncture or incinerate the Spray Collar or the refill canister. Do not expose to extreme heat or store at temperatures above 113°F.

Refill canisters are available in citronella or unscented spray. Contact the Customer Care Center or visit our web site at petsafe.com to locate a retailer near you.

Testing the Spray Collar

NOTE: Keep the Spray Collar away from your face during testing.

1. Turn the Spray Collar on.
2. The Spray Collar LED will turn solid green for 1 second.
3. Next the LED will turn solid yellow for 2 seconds.
4. As soon as the LED is yellow, turn the Spray Collar off.
5. Wait 2 seconds with the Spray Collar off.
6. Then turn the Spray Collar on.
7. The LED will flash yellow to indicate that the unit is in test mode.
8. During the flashing of the yellow LED rub the Spray Collar with a coin to create a vibration. After it has sprayed, it will have a time-out of about 10-15 seconds before it can be tested again. After approximately 1 minute, the LED flashes green to indicate the Spray Collar is now in normal operation again.

What to Expect During Use of the Spray Collar

Important: Do not leave your dog alone the first few times he wears the Spray Collar.

Place the Spray Collar properly on your dog and wait nearby until he barks. Most dogs will understand very quickly that the Spray Collar is disrupting their urge to bark and will relax and stop barking. Because the burst of spray from the Spray Collar may be surprising or startling at first, some dogs may bark more at the initial correction.

On rare occasions, a dog may get into a bark-spray-bark-spray cycle. If this happens, reassure your dog with calm, soothing tones. As your dog relaxes, he will understand that if he becomes quiet, he will not receive any more spray bursts. The small minority of dogs that have this reaction should only have it the first time they wear the Spray Collar.

You should notice a reduction in your dog's barking within the first couple of days that he wears the Spray Collar. At this point, it is important to remember the learning process is still not complete. Dogs will "test" this new learning experience and will increase their attempts to bark. This usually occurs during the second week a dog wears the Spray Collar. If this does occur, remain consistent and do not alter your use of the Spray Collar. You must place the Spray Collar on your dog in every situation when you expect him to be quiet. If your dog is not wearing the Spray Collar, he may resume barking and his learning would suffer a setback.

Tips and Maintenance

- Before playing with your dog, turn the device off and remove it from your dog. The activity may cause your dog to bark, which could lead to him associating the play with the burst of spray.
- The Spray Collar must be filled to maximum capacity before placing it around your dog's neck.
- Never fill the Spray Collar while your dog is wearing it because it may damage the Refill Port.
- To ensure that your dog does not make the connection between you and the Spray Collar, don't let him see you prepare the Spray Collar for the first try, or for subsequent use. Keep your dog away while you prepare the Spray Collar as well as when you fill it or change the battery.
- Remove all other collars with metallic parts or tags. These could create noise that may needlessly activate the Spray Collar.
- Avoid letting your dog wear the Spray Collar with an empty reservoir. Make sure it is always full.
- Turn off the Spray Collar while not in use.
- The Spray Collar should only be used with pets that are over 6 months of age.
- If your pet is injured or its mobility is otherwise impaired, contact your veterinarian or professional trainer before use.
- Do not leave your Spray Collar unattended where your dog could accidentally damage it through chewing.
- Never fill the Spray Collar with any substance other than the one provided by the manufacturer. Using another substance, as well as opening the device, will void the manufacturer's warranty.
- Do not attempt to repair the device yourself. This will invalidate the warranty and make repairs more difficult.
- The spray from the Spray Collar may stick to the hair under your dog's snout. Clean your dog's hair weekly with a washcloth and a mild hand soap. Rinse and dry your dog's neck thoroughly.
- If the spray accumulates on the Spray Collar, wipe the receiver clean with a damp cloth and dry thoroughly.

Frequently Asked Questions

Will another dog's bark set off the Spray Collar?	<ul style="list-style-type: none"> • No.
Will the Spray Collar work for my dog?	<ul style="list-style-type: none"> • The Spray Collar is safe and effective for all breeds and sizes of dogs; however, it is recommended for little dogs.
Will this work with long-haired dogs?	<ul style="list-style-type: none"> • Yes. It may be necessary to trim the hair on your dog's neck so it does not block the spray from reaching his snout.
Does the spray need to hit my dog's nose?	<ul style="list-style-type: none"> • No. The spray is very fine and simply creates a mist in the region of the snout.
Can I attach a lead to the Spray Collar?	<ul style="list-style-type: none"> • Do not attach a lead to the Spray Collar. You may put a separate non-metallic collar or harness on your dog's neck and attach a lead and/or tags. <i>Note: Be sure the extra collar does not interfere with the path of the spray.</i>

Troubleshooting

The Spray Collar does not spray.	<ul style="list-style-type: none"> • Ensure that the battery is properly installed. • Replace the battery. • Ensure the unit is on. • Refill the spray. • Follow the testing instructions listed in the guide. • If the Spray Collar still does not spray, contact the Customer Care Center.
My Spray Collar sprays, but my dog keeps barking (does not respond to the burst of spray).	<ul style="list-style-type: none"> • Tighten the Spray Collar. • Check to make sure the Spray Nozzle points towards the dog's snout. • Make sure your dog's hair does not block the spray. If so, trim the hair so the spray can reach the snout area. • If your dog still does not respond, contact the Customer Care Center.
When I try to refill the spray, the spray leaks out around the Spray Nozzle.	<ul style="list-style-type: none"> • Hold the spray can upright. If it is held at an angle, it will not create a good seal. • Press firmly on the spray can to create a good seal. • If the spray still continues to leak, contact the Customer Care Center.
I have refilled the Spray Collar and the yellow LED continues to flash.	<ul style="list-style-type: none"> • Ensure the spray counter has been reset. Note: See "To Fill and Refill the Spray" section. • If the yellow LED continues to flash after the spray counter has been reset, contact the Customer Care Center.

Customer Care International

USA - Tel: 800-732-2677

Monday - Friday 8 AM - 8 PM / Saturday 9 AM - 5 PM

Australia - Tel: 1800 786 608

Monday - Friday 8:30 AM - 5 PM

New Zealand - Tel: 0800 543 054

Monday - Friday 10:30 AM - 7 PM

Terms of Use and Limitation of Liability

1. Terms of Use

The use of this product is subject to your acceptance without modification of the terms, conditions and notices contained with this product. Use of this product implies acceptance of all such terms, conditions, and notices. If you do not wish to accept these terms, conditions, and notices, please return the product, unused, in its original packaging and at your own cost and risk to the relevant Customer Care location together with proof of purchase for a full refund.

2. Proper Use

Proper Use includes, without limitation, reviewing the entire Product Manual and any specific safety information statements. The specific temperament or size/weight of your pet may not be suitable for this product. If you are unsure whether this product is appropriate for your pet, please consult your veterinarian or certified trainer prior to use. For products used with pets where training is desired, Radio Systems Corporation recommends that these training products are not used if your pet is aggressive and accepts no liability for determining suitability in individual cases.

3. No Unlawful or Prohibited Use

This product is designed for use with pets only. This product is not intended to harm, injure or provoke. Using this product in a way that is not intended could result in violation of Federal, State or local laws.

4. Limitation of Liability

In no event shall Radio Systems Corporation or any of its associated companies be liable for (i) any direct, indirect, punitive, incidental, special or consequential damage and/or (ii) any loss or damages whatsoever arising out of or connected with the use or misuse of this product. The Purchaser assumes all risks and liability from the use of this product to the fullest extent permissible by law.

5. Modification of Terms and Conditions

Radio Systems Corporation reserves the right to change the terms, conditions and notices governing this product from time to time. If such changes have been notified to you prior to your use of this product, they shall be binding on you as if incorporated herein.



Battery Disposal

Separate collection of spent batteries is required in many regions; check the regulations in your area before discarding spent batteries. At the end of the product life, please contact our Customer Care Center to receive instructions on proper disposal of the unit. Please do not dispose of the unit in household or municipal waste. For a listing of Customer Care Center telephone numbers in your area, visit our website at petsafe.com.



Important Recycling Advice

Please respect the Waste Electrical and Electronic Equipment regulations in your country. This equipment must be recycled. At the end of the product life, do not place it in the normal municipal waste system. Please check the regulations in your area or return it to where it was purchased so that it can be placed in our recycling system. If these options are not possible, please contact the Customer Care Center for further information.

Perchlorate Battery

Perchlorate Material – special handling may apply.
See www.dtsc.ca.gov/hazardouswaste/perchlorate.

FCC

This device complies with part 15 of the FCC Rules. Operation is subject to the following two conditions: (1) This device may not cause harmful interference, and (2) this device must accept any interference received, including interference that may cause undesired operation.

NOTE: This equipment has been tested and found to comply with the limits for a Class B digital device, pursuant to part 15 of the FCC Rules. These limits are designed to provide reasonable protection against harmful interference in a residential installation. This equipment generates, uses, and can radiate radio frequency energy and, if not installed and used in accordance with the instructions, may cause harmful interference to radio communications. However, there is no guarantee that interference will not occur in a specific installation. If interference does occur to radio or television reception, which can be determined by turning the equipment off and on, the user is encouraged to try to correct the interference by one or more of the following measures:

- Relocate the interfered receiving antenna.
- Increase the separation between the equipment and receiver.
- Connect the equipment into an outlet on a circuit different to that to which the receiver is connected.
- Contact the Customer Care Center at +1 (800) 732-2677.

CAUTION: Modification or changes to this equipment not expressly approved by Radio Systems Corporation may void the user's authority to operate the equipment.

Warranty

One Year Non-Transferable Limited Warranty

This Product has the benefit of a limited manufacturer's warranty. Complete details of the warranty applicable to this Product and its terms can be found at petsafe.com and/or are available by contacting your local Customer Care Center.

Radio Systems Corporation
10427 PetSafe Way
Knoxville, TN 37932 USA
(865) 777-5404

J400-1549/3

©2021 Radio Systems Corporation