

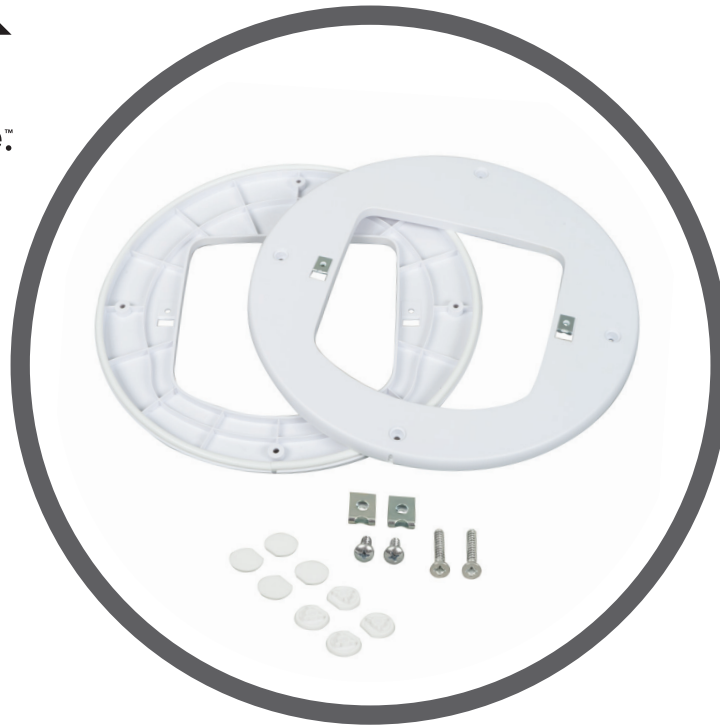

protect. teach. love.™



## Microchip Cat Flap Installation Adaptor

PAC54-16246

Instructions for use

**100**  
Series

### Installation – Wooden, PVC, or uPVC Doors

Before beginning, please check if your door has a metal core. If a metal core or metal plate is found, please refer to the *Installation Metal and Metal Core Doors* section of this guide.

1. Attach the supplied Cutting Template to the outside of your door in the correct position ensuring that it is the right way up and level (**Fig. C**).
2. Drill four corner holes with a 12 mm diameter drill bit as marked on the Cutting Template through the door. Please ensure the drill remains straight and level.

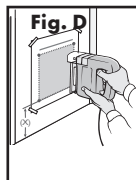
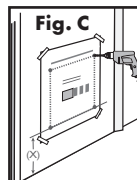

3. Using a jig or key-hole saw, cut along the dashed line as indicated on the Cutting Template. (**Fig. D**).
4. Temporarily place both frames into the cutout. Level the cat flap until it is in the proper position. On the outside, use a pencil to mark screw holes through the holes on the exterior frame (**Fig. E**). Remove the cat flap and drill the screw holes with a 6mm drill (**Fig. F**).
5. Clean the area from any dust, dirt or debris.

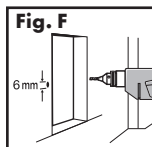
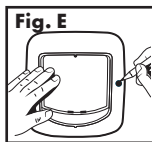

6. Place the interior frame (with attached tunnel) into the hole from the inside. Align the exterior frame to the outside of the door. Three (3) different lengths of screws have been provided with this cat flap. Select the appropriate length. Using a manual screw driver, screw the exterior frame through the holes in your door to the interior frame.

**Important:** Do not cut the tunnel. Key components are contained within the tunnel and any alteration to the tunnel will affect functionality.

7. When the installation of the cat flap is completed, place the two blanking plugs over the screws on the exterior frame. The cat flap is ready to use (**Fig. G**).

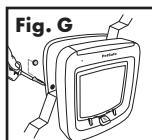

### Installation – Metal or Metal Core Doors

Installation of the cat flap into a metal door or a door with a metal core plate will require some modifications. The presence of metal can interfere with the performance of the cat flap including a reduction in read range of the microchip. If you experience poor performance you may need to purchase and install an Installation Adaptor and follow the instructions in the *Installation – Glass Doors or Windows* section of this guide.

### Installation – Glass Doors or Windows

The PetSafe® Microchip Cat Flap is also designed for installation into glass and requires a circular hole with a diameter of 212 mm and an Installation Adaptor (sold separately). Your glazier will need to cut a circular hole of diameter 212 mm as per the cutting template. Once a glazier has cut the hole in your glass door or window please follow the instructions below for installation.

1. Slide one adaptor plate over the tunnel on the interior side of the frame of the cat flap.
2. From the interior of home, install the cat flap into opening.
3. From exterior of home, slide second adaptor over the tunnel of the cat flap.
4. Install exterior frame of the cat flap over the attached tunnel.
5. Using appropriate length screws, connect the interior and exterior frames of the cat flap.
6. Insert blanking plugs (included).

**CAUTION** Working with glass is a skilled job and should be carried out by a professional glazier. It is not possible to cut holes in toughened glass or double glazed units except at the time of manufacture. Please consult a glazier.