



Käyttöopas
Bruksanvisning
Bruksanvisning
Betjeningsvejledning
Пособие по эксплуатации
Operating Guide

D360-EU-19

Drinkwell® 360 lemmikin juomalähde - 3,8 litraa

Drinkwell® 360 drickfontän för husdjur - 3,8 liter

Drinkwell® 360 vannautomat til kjæledyr - 3,8 liter

Drinkwell® 360 vandpost til kæledyr - 3,8 liter

Поилка для домашних животных Drinkwell® 360 - 3,8 литров

Drinkwell® 360 Pet Fountain - 3.8 Litres

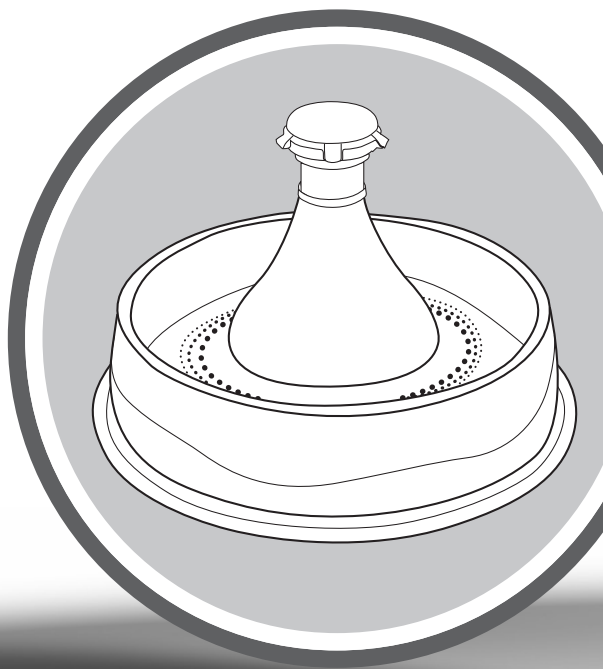

protect. teach. love.™

Lue tämä opas kokonaan ennen kuin aloita
Läs hela handboken innan du använder apparaten
Les hele bruksanvisningen for du starter
Læs hele denne vejledning for brug

Перед началом эксплуатации полностью прочтите данное пособие
Please read this entire guide before beginning

Hereinafter Radio Systems Corporation, Radio Systems PetSafe Europe Ltd., Radio Systems Australia Pty Ltd. and any other affiliate or Brand of Radio Systems Corporation may be referred to collectively as “We” or “Us”.

IMPORTANT SAFETY INFORMATION

Explanation of Attention Words and Symbols used in this guide



This is the safety alert symbol. It is used to alert you to potential personal injury hazards. Obey all safety messages that follow this symbol to avoid possible injury or death.

⚠ WARNING

WARNING indicates a hazardous situation which, if not avoided, could result in death or serious injury.

CAUTION

CAUTION, used without the safety alert symbol, indicates a hazardous situation which, if not avoided, could result in harm to your pet.

NOTICE

NOTICE is used to address safe use practices not related to personal injury.

⚠ WARNING

When using electrical appliances, basic safety precautions should always be followed to reduce the risk of fire, electric shock and/or injury to persons, including the following:

- To reduce the risk of injury, close supervision is necessary when an appliance is used by or near children.
- To protect against electric shock, do not place electrical Power Cord or plug in water or other liquids.
- Do not use outdoors. Do not run dry. FOR INDOOR HOUSEHOLD USE ONLY.
- Do not pull on the electrical Power Cord to remove the plug from the electrical outlet. To unplug, grasp the plug, not the electrical Power Cord.
- Do not operate any appliance if it has a damaged electrical Power Cord or plug, or if it is malfunctioning or has been damaged. Call Customer Care Centre immediately for further instructions.
- For a portable appliance - To reduce the risk of electric shock, do not place or store an appliance where it can fall or be pulled into a bath tub or sink.
- Always unplug any appliance when not in use, before putting on or taking off parts and before cleaning.
- Do not use an appliance for anything other than its intended use.
- If the plug of this device gets wet, turn off the electricity to that electrical outlet. Do not attempt to unplug.
- Examine this appliance after installation. Do not plug into electrical outlet if there is water on the electrical Power Cord or plug.

CAUTION

- Do not allow pets to chew on or swallow any parts. If you are concerned about the electrical Power Cord, purchase a cord conduit (a hard plastic protector) at any hardware store.
- The plastic Pet Fountain parts are BPA-FREE. However, some animals have been known to be sensitive to plastic food and water containers. If your animal shows signs of an allergic reaction to the plastic, please discontinue use until you have consulted with your veterinarian.

NOTICE

- The Pet Fountain is intended to run continuously (always plugged into electricity), as long as the water level is maintained and the Pet Fountain is cleaned regularly. Be sure to check the Pet Fountain regularly to help prevent damage to the Pump, as the water may get consumed or evaporate causing the Pump to run dry.
- Do not attempt repairs on the Pump yourself.
- To avoid the possibility of the plug or outlet getting wet, the outlet should always be above the level of the Pet Fountain.
- If an extension cord is necessary, an extension cord with a proper rating should be used.
- The electrical use of this appliance is 2.5 watts.
- Do not use appliance for anything other than intended use. The use of attachments not recommended or sold by the manufacturer may cause an unsafe condition. Do not modify the unit.
- Do not install or store appliance where it will be exposed to weather or temperatures below 4.5° C.
- Read and observe all important notices listed on the appliance and in the packaging.
- Never wash the filters with soapy water, as the soap residue will seep into the filters and cannot be removed. Only rinse the filters with water.

SAVE THESE INSTRUCTIONS

Thank you for choosing the PetSafe® Brand. You and your pet deserve a companionship that includes memorable moments and a shared understanding together. Our products and training tools enhance the relationship between pets and their owners. **If you have any questions about our products or training your pet, please visit our website at www.petsafe.net or contact our Customer Care Centre. For a listing of Customer Care Centre telephone numbers, visit our website at www.petsafe.net.**

To get the most protection out of your warranty, please register your product within 30 days at www.petsafe.net. By registering and keeping your receipt, you will enjoy the product's full warranty and should you ever need to call the Customer Care Centre, we will be able to help you faster. Most importantly, your valuable information will never be given or sold to anyone. Complete warranty information is available online at www.petsafe.net.

Table of Contents

Components	80
Features	80
Key Definitions	81
Operating Instructions	82
Filters and Pet Fountain Cleaning	84
Pump Maintenance	86
Pet Fountain Reassembly	87
The Pet Fountain and Your Environment	88
Tips On Use	89
Troubleshooting	89
Warranty	90
Compliance	91
Important Recycling Advice	91
Terms of Use and Limitation of Liability	92

Components

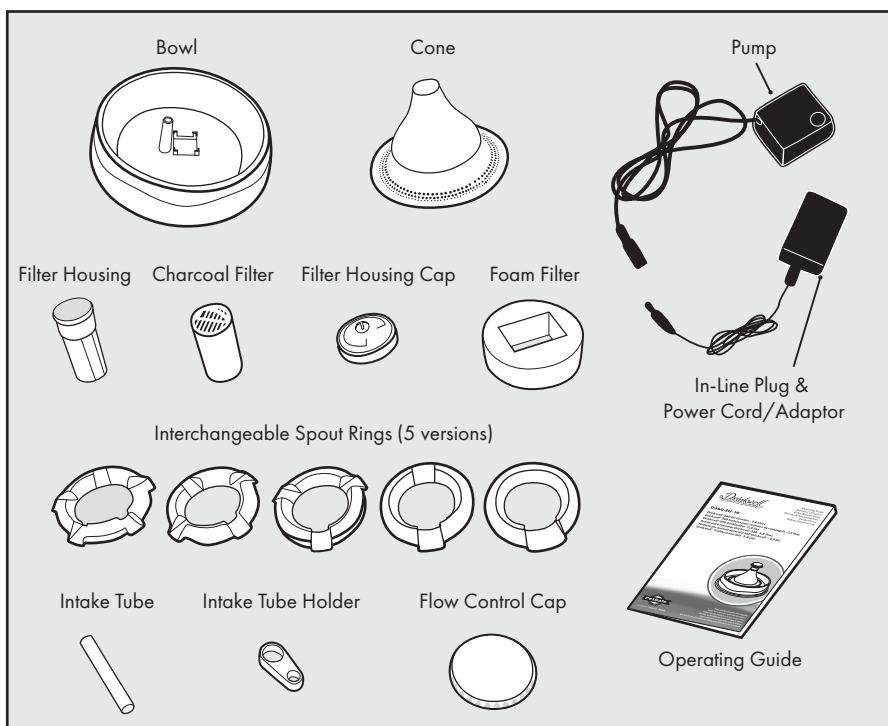

Note: Your Pet Fountain will come partially assembled, however, it is a good idea to make sure none of the Pet Fountain pieces have come loose in shipping.

Features

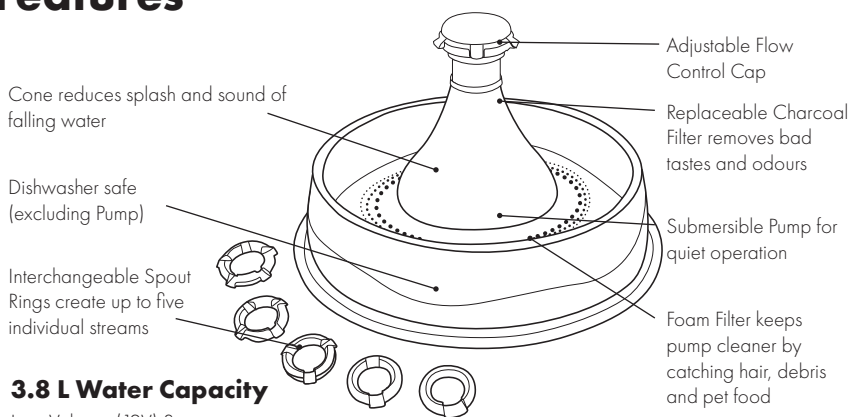

3.8 L Water Capacity

Low-Voltage (12V) System

Key Definitions

Bowl: The Bowl is the foundation of the Pet Fountain. The circular Bowl piece can be carried by simply gripping the sidewalls underneath the Bowl.

Cone: The Cone acts as the housing for the Pet Fountain components and protects the Pump from curious pets. The Cone acts to reduce the splash and sound of the falling water.

Filter Housing: The Filter Housing slides into the opening at the top of the Cone. It houses the Filter and locks into the Cone by twisting the entire Filter Housing a quarter turn.

Charcoal Filter: The cylindrical Charcoal Filter features a pull-tab at the top and should be placed in the Filter Housing with the pull-tab facing upwards for easy placement and removal.

Foam Filter: The Foam Filter collects hair, debris and pet food before they reach the Pump. It is important to use the Foam Filter as it helps maintain proper Pump function.

Filter Housing Cap: The Filter Housing Cap is a screw on cap that attaches to the Filter Housing to keep the Filter in place. It serves as the base piece to attach the Interchangeable Spouts & Flow Control Cap.

Spout Rings: The five Interchangeable Spout Rings can be easily changed based upon your pet's preference and can provide up to 5 streams of water for multiple pet households.

Flow Control Cap: The Flow Control Cap is attached to the top of the Pet Fountain and adjusts the flow of water by simply turning the Flow Control Cap left or right. Turn to the right to increase the flow of water. Turn to the left to decrease.

Pump: The small submersible aquarium Pump can be dismantled for cleaning.

Important: THE PUMP IS NOT DISHWASHER SAFE! Remove Pump from Pet Fountain prior to cleaning (See "Pump Maintenance"). The Pump features an In-Line Plug for easy attachment and removal.

FI

SV

NO

DA

RU

EN

Operating Instructions

Important: DO NOT RUN DRY - FOR INDOOR USE ONLY.

1. As with any electrical device, check the electrical Power Cord for any tears, or damage before use.
2. Make sure the In-Line Plug is connected (**Fig. 1**).
3. Remove Cone piece by twisting anti-clockwise to unlock the tabs from the Bowl (**Fig. 2**). Lift up and set aside.
4. Check to make sure the Intake Tube is properly inserted (pushed all the way down) into the Pump (**Fig. 3**).
5. Replace Cone and twist clockwise to lock tabs in place (**Fig. 4**).
6. Take the partially assembled Filter Housing and remove the Flow Control Cap by gently lifting straight up - DO NOT TWIST TO REMOVE (**Fig. 5**). Gently lift up and remove the Spout Ring to access the Filter Housing Cap.
7. Unscrew Filter Housing Cap and insert the Charcoal Filter into the Filter Housing with the pull-tab facing up (**Fig. 6**). The Charcoal Filter will slide easily into place. Next, screw on the Filter Housing Cap (**Fig. 7**).

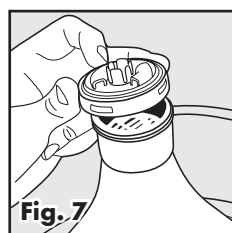
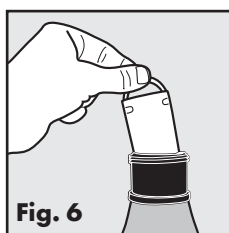
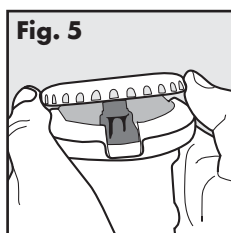
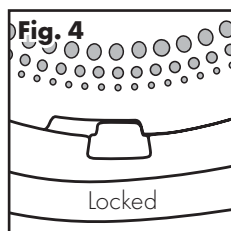
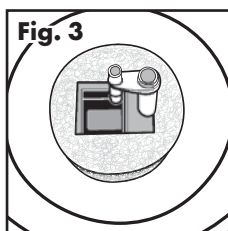
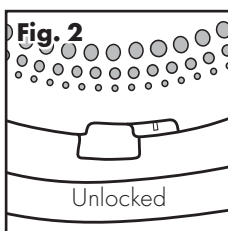
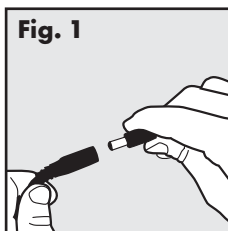

Important: Rinse the Charcoal Filter thoroughly under cold water before placing into the housing. This will remove any loose charcoal dust, which is harmless to your pet. A small amount of charcoal dust may be gradually released for the life of the Filter. This is normal and not harmful to your pet.

8. Align the side grooves of the Filter Housing with the inner notches of the Cone opening. The Filter Housing should slide easily into place. Turn Filter Housing a quarter turn to the right (clockwise) until it locks in place (**Fig. 8**).
9. Select one of the five interchangeable Spout Rings based upon your personal preference or your pet's. Place the chosen Spout Ring on top of Filter Housing Cap and gently press down evenly to secure in place (**Fig. 9**).
10. Align Flow Control Cap with the raised notches (**Fig. 10**) on the Filter Housing Cap. Press down gently and the cap will snap into place. With the Flow Control Cap, you will be able to easily adjust the flow intensity of the water. Turn the cap to the right to increase the flow and turn to the left to decrease.

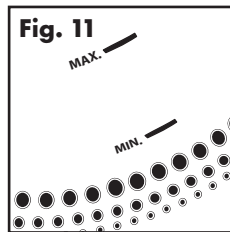
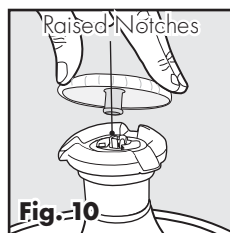
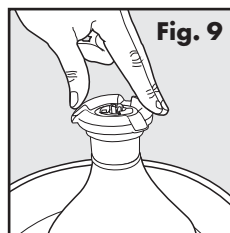
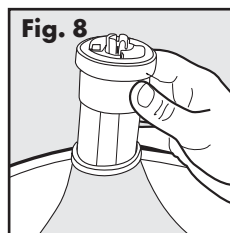

Important: If you notice a decrease in the flow of the water that is not corrected by turning the Flow Control Cap toward max this may be an indication of a clogged and dirty Filter and/or the need to rinse and clean the Filter Housing. Consult the "Filters and Pet Fountain Cleaning" section of this Operating Guide for details on cleaning and maintaining your Pet Fountain.

11. Place Pet Fountain in desired location. Do not pick up a full Pet Fountain by the Cone piece. To properly pick up the Pet Fountain, use both hands and grip the sidewalls of the Pet Fountain Bowl and lift. **Important:** To take care of your floors, always use a protective mat, such as a towel or place mat. This will help protect your floor from any water that may splash out from your pet's use of the Pet Fountain.
12. Fill the Pet Fountain Bowl with water. Make sure the water level is at least to the MIN (minimum) fill line so the Pump does not run dry. This will prime the Pump for use. Do not fill the Pet Fountain past the MAX (maximum) fill line.
13. Before you plug in the Pet Fountain make sure the Power Cord and your hands are dry. Plug the Pet Fountain in to an electrical outlet.
14. Add water as needed. Never let the water level fall lower than the MIN (minimum) fill line (approx. 2.5 cm above the bottom of the Bowl, **Fig. 11**) or the Pump may fail. Replacement Pumps are sold separately by calling a Customer Care Centre. Visit www.petsafe.net for a telephone listing of the Customer Care Centre near you.

Filters and Pet Fountain Cleaning

FILTER SYSTEM

The Pet Fountain is equipped with two types of filters that should be replaced on a regular basis. The Charcoal Filter removes bad tastes and odours, keeping water fresh. The Foam Filter collects hair, debris and pet food and prevents them from reaching the Pump, providing optimal filtration. The filters together will keep the Pump cleaner and provide fresher water to your pet.



Charcoal Filter: Filters should be changed every two to four weeks.

Replace filters more frequently when using the Pet Fountain for multiple pets or pets that produce a lot of saliva. **Important:** Always rinse the Charcoal Filter prior to use. A small amount of charcoal dust may be released for the life of the filter, this is normal and is not harmful to your pet.

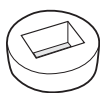

Foam Filter: Replace the Foam Filter every one to two months, depending on the location of the Pet Fountain and the number of pets using it. If you do not intend to replace the filter at the time of cleaning, rinse the Foam Filter thoroughly with fresh water.

Filters are an added feature of the Pet Fountain. Using the filters is not required for normal operation. However, when used properly and changed regularly, the filters help keep the water cleaner and fresher, while extending the life of your Pet Fountain. Filters may be rinsed out when the Pet Fountain is cleaned. **Important:** Never wash the filters with soapy water, as the soap residue will seep into the filters and cannot be removed. Only rinse the filters with water.

PET FOUNTAIN

Important: Clean Pet Fountain once a week.

The Pet Fountain must be cleaned on a regular basis to continue working normally.

1. Unplug Pet Fountain from electrical source and disconnect the In-Line Plug from the Pump (**Fig. 12**).
2. Remove the Flow Control Cap and Spout Ring.
3. Remove the Filter Housing by twisting the Filter Housing Cap anti-clockwise to the unlock position. Lift directly up and set aside.
4. Empty the water out of the Pet Fountain.
5. Once the Pet Fountain is empty, remove the Cone piece by twisting anti-clockwise to unlock the tabs. Lift up and set aside.

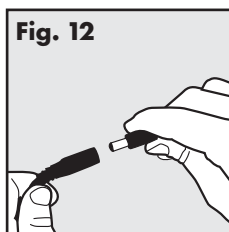
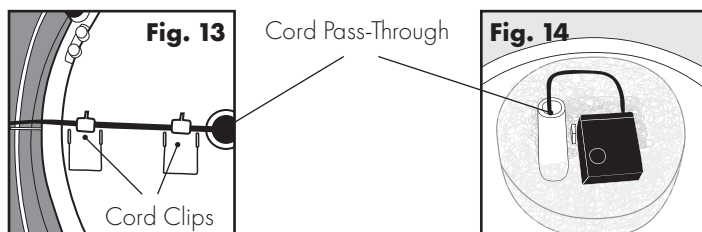
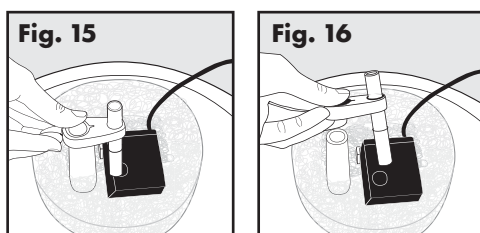

Fig. 12

6. Next, flip the Bowl upside down and unhook the electrical Power Cord from the two Cord Clips (**Fig. 13**). This will allow you to pull the electrical Power Cord through the Cord Pass-Through in the Bowl (**Fig. 14**).



7. Remove the Intake Tube by lifting up on the Intake Tube Holder to free the Intake Tube from the Pump (**Fig. 15 & 16**). This will allow you to remove the Pump. The Intake Tube can then be pulled from the Intake Tube holder.



8. Remove the Foam Filter from the Pump. Clean away any hair, debris or pet food that may have accumulated on the Faceplate of the Pump (See "Pump Maintenance" section for detailed cleaning instructions for the Pump).
9. Once the Pet Fountain is completely disassembled you will have 8 plastic parts.
10. Clean the plastic Pet Fountain parts with warm water and soap. You can also put the Pet Fountain in the top rack of the dishwasher. Remove the Pump before placing the Pet Fountain in the dishwasher. **DO NOT PLACE PUMP IN DISHWASHER!** If possible, it is recommended that you turn down the heat of the water inside the dishwasher.
11. If you have trouble reaching certain spots or hard-to-reach corners, try using a cotton swab or purchase the Drinkwell® Cleaning Kit, a 3-Piece Brush Kit. To purchase a Cleaning Kit, visit our website at www.petsafe.net to locate a retailer near you or to find a listing of Customer Care Centre telephone numbers for your area.

Pump Maintenance

Important: Cleaning the Pump is essential to the longevity of the Pet Fountain as well as the cleanliness of the water. Clean the Pump at least every two weeks. Warranty may be voided if the Pump is not cleaned regularly.

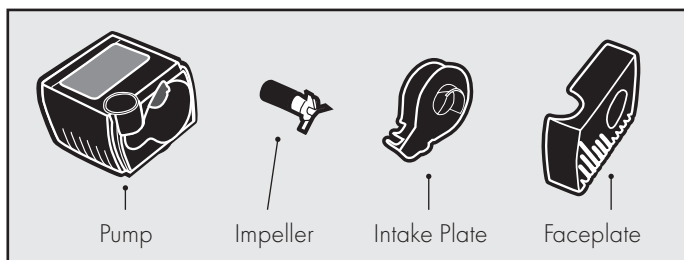

1. Remove Pump from the Pet Fountain as explained in the "Filters and Pet Fountain Cleaning" section of this Operating Guide.
2. Once the Pump is out of the Pet Fountain, with your thumb and forefinger, gently squeeze on either side of the Faceplate, and pull it off. It may be necessary to insert a fingernail into the seam of the Faceplate to pry it off (**Fig. 17**).
3. Next remove the Intake Plate by placing your fingernail under the small lip located on the narrow side of teardrop-shaped Intake Plate Pull-Tab and pull out to remove (**Fig. 18**).
4. Once the Intake Plate is removed you can also remove the Impeller (white, 3-bladed propeller) which is held in place magnetically. To remove the Impeller, insert a fingernail or other slim object underneath the plastic blade and lift out of Pump (**Fig. 19**).

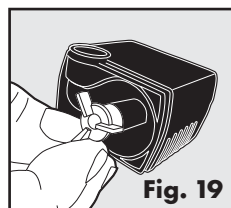
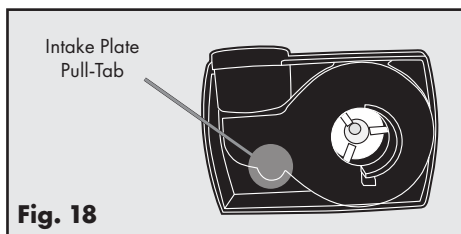
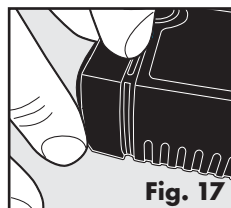

5. Once the Pump is disassembled you can clean the parts with warm soap and water. Use a cotton swab or the "motor" brush from the Drinkwell® Cleaning Kit to get into the Pump's motor cavity and remove any build-up (**Fig. 20**). For added disinfecting and hard water removal, clean the Pump's motor cavity with a diluted vinegar solution (20% white vinegar & 80% water). Be sure to rinse thoroughly with fresh water.

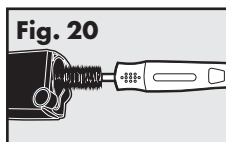

6. Once the parts are clean you can reassemble the Pump for use.
- Replace the Impeller.
 - Replace the Intake Plate.
 - Replace the Faceplate.

Pet Fountain Reassembly

- Place the Foam Filter around the Pump. Make sure the electrical Power Cord runs over the top of the Foam Filter, not underneath it, as this will keep the Foam Filter in place.
- With the Foam Filter securely around the Pump, replace the Pump into its location between the four posts in the centre of the Bowl. Be sure to position the circular opening on the top of the Pump next to the Cord Pass-Through in the Bowl. Gently push down to engage the suction cups.
- Replace the Intake Tube into the Intake Tube Holder, then place the Intake Tube Holder back onto the Cord Pass-Through aligning the guideline on the post with the notch in the Intake Tube holder. Be careful to align the Intake Tube so that it fits into the circular opening on the top of the Pump.
- Thread the In-Line Plug through the Cord Pass-Through next to the Pump (**Fig. 21**). On the bottom side of the Bowl, clip the electrical Power Cord into place using the Cord Clips (**Fig. 22**). Next, guide the electrical Power Cord through the Notch in the side of the Bowl (**Fig. 23 & 24**).

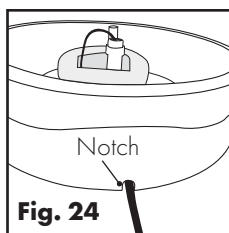
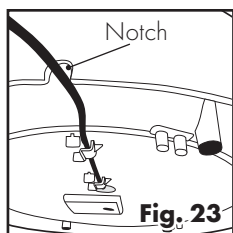
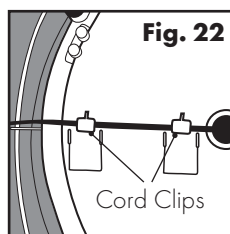
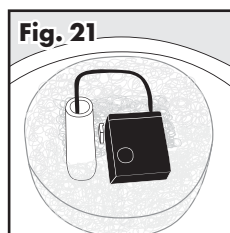

5. Align the three notches around the Cone with the corresponding tabs in the bowl. Next, turn the Cone piece to the right (clockwise) to lock tabs into place (**Fig. 25 & 26**).

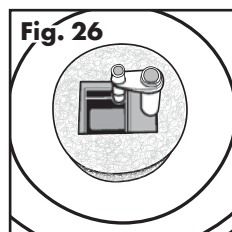
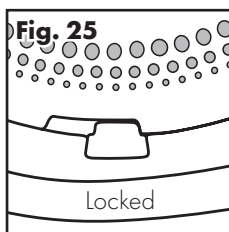

6. Screw on Filter Housing Cap and slide the Filter Housing into place in the hole at the top of the Cone. Turn Filter Housing a quarter turn to the right (clockwise) to lock in place.
7. Place chosen Spout Ring on top of the Filter Housing Cap and press down gently to secure in place.
8. Replace the Flow Control Cap by aligning it with the notches on the Filter Housing Cap. Gently push down to secure in place (**Fig. 27**).

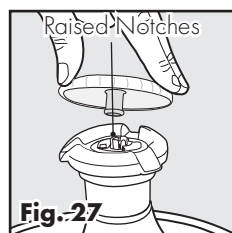

9. Place Pet Fountain in desired location. **Important:** To take care of your floors, always use a protective mat, such as a towel or place mat. This will help protect your floor from any water that may splash out from your pet's use of the Pet Fountain.
10. Fill the Pet Fountain Bowl with water. Make sure the water level is at least to the MIN (minimum) fill line so the Pump does not run dry. Do not fill the Pet Fountain past the MAX (maximum) fill line.
11. Make sure the electrical Power Cord, the Adaptor and your hands are completely dry before you plug the Pet Fountain into an electrical outlet. Connect the Inline Plug and make sure no silver is showing, then plug the Adaptor into an electrical outlet.

The Pet Fountain and Your Environment

If you live in a humid environment and have problems with mold or algae, soak all fountain parts in a diluted vinegar solution (20% White Vinegar and 80% Water) for 10 minutes after regular cleaning. Also, pour the diluted vinegar solution into the Pump's motor cavity.

If you have hard water, small white mineral deposits may form on or inside the Pump. This can eventually prevent the Impeller from turning properly. To avoid replacement or damage to the Pump, please take the following precautions:

- Clean the Pump more frequently.
- Clean the Pump with a diluted vinegar solution weekly.
- Use bottled water instead of tap water.

Tips On Use

- When being introduced to the Pet Fountain, your pet may be cautious of this new and unusual object. After beginning operation of your Pet Fountain, simply allow your pet to adjust at his or her own pace. Some pets may take several days or longer to begin use, while others will start right away.
- Your pet may prefer that the Pet Fountain be placed away from their normal feeding area. Try placing it in another location, such as a different area of the kitchen or in a bathroom or utility room.
- Add ice cubes to the bowl for refreshing, ice-cold running water!

Troubleshooting

The answers to these questions should help you solve most problems you may have with the Pet Fountain. If they do not, please contact our Customer Care Centre.

TROUBLESHOOTING	
PROBLEM	SOLUTION
Pump is not working or the water flow is low.	<ul style="list-style-type: none"> • The Pump needs to be taken apart and cleaned every two weeks. See "Pump Maintenance" section for detailed instructions. • Carbon in Carbon Filter may need to be redistributed. Remove Carbon Filter and rinse with cold water. Tap Filter a couple of times to redistribute granulated carbon.
Pet Fountain is loud/gurgling.	<ul style="list-style-type: none"> • Check water level. If Pet Fountain water level gets too low the Pump will have to work harder causing it to be louder than normal. • Take apart and clean Pump. See "Pump Maintenance" section for detailed instructions.
Pet Fountain seems dirty even after cleaning.	<ul style="list-style-type: none"> • If you have hard water, small white mineral deposits may form on or inside the Pump. Clean with white vinegar and allow to soak in diluted vinegar for approximately 20 minutes.
There are black particles in the Bowl.	<ul style="list-style-type: none"> • This is loose charcoal from the Carbon Filter and is completely harmless for your pet to drink. Rinse the Carbon Filter in cold water before placing it in the Pet Fountain to prevent this.
The Pet Fountain has a slimy film on it.	<ul style="list-style-type: none"> • This may be caused by your pet's saliva. Change the water and clean your Pet Fountain more frequently to prevent this.
The Power Adaptor is warm to the touch.	<ul style="list-style-type: none"> • Unplug the Pet Fountain and plug it into a surge protector.

Warranty

Two Year Non-Transferrable Limited Warranty

This Product has the benefit of a limited manufacturer's warranty. Complete details of the warranty applicable to this Product and its terms can be found at www.petsafe.net and/or are available by contacting your local Customer Care Centre.

Europe – Radio Systems PetSafe Europe Ltd., 2nd Floor, Elgee Building
Market Square, Dundalk, Co. Louth, Ireland

Canada – Radio Systems Corporation, 10427 PetSafe Way, Knoxville, TN 37932 USA

Australia/New Zealand – In compliance with the Australian Consumer Law, Warranties Against Defects, effective January 1, 2012, warranty details of this Product are as follows: Radio Systems Australia Pty Ltd. (hereinafter referred to as "Radio Systems") warrants to the original retail purchaser, and not any other purchaser or subsequent owner, that its Product, when subject to normal and proper residential use, will be free from defects in material or workmanship for a period of two (2) years from the purchase date. An "original retail consumer purchaser" is a person or entity who originally purchases the Product, or a gift recipient of a new Product that is unopened and in its original packaging. When serviced by Radio Systems Customer Service, Radio Systems covers labour and parts for the first two years of ownership; after the first two years, a service or upgrade charge will apply relative to replacement of the Product with new or refurbished items at Radio Systems' sole discretion.

The limited warranty is non-transferrable and shall automatically terminate if the original retail consumer purchaser resells the Radio Systems Product or transfers the property on which the Radio Systems Product is installed. This Limited Warranty excludes accidental damage due to dog chews; lightning damage; or neglect, alteration, and misuse. Consumers who purchase products outside of Australia, New Zealand, or from an unauthorised dealer will need to return the Product to the original place of purchase for any warranty issues.

Please note that Radio Systems does not provide refunds, replacements, or upgrades for change of mind, or for any other reason outside of these Warranty terms.

Claims Procedure: Any claim made under this Warranty should be made directly to Radio Systems Australia Pty Ltd. Customer Care Centre at:

Radio Systems Australia Pty Ltd.

PO Box 7266, Gold Coast Mail Centre QLD 9726, Australia

Australia Residents: 1800 786 608

New Zealand Residents: 0800 543 054

Email: info@petsafeaustralia.com.au

To file a claim, a proof of purchase must be provided. Without a proof of purchase, Radio Systems will not repair or replace faulty components. Radio Systems requests the Consumer to contact the Radio Systems Customer Care Centre to obtain a Warranty Return number, prior to sending the Product. Failure to do so may delay in the repair or replacement of the Product.

If the Product is deemed to be faulty within 30 days from date of original purchase, Radio Systems will organise for a replacement to be sent in advance of returning the faulty Product. A Post Bag will be included with the replacement Product for the return of the faulty Product. The Product must be returned within 7 days of receiving the replacement. If the Product is deemed to be faulty after 30 days from the date of original purchase, the consumer will be required to return the Product to Radio Systems at the consumer's own expense. Radio Systems will test and replace the faulty unit or its components and return to the consumer free of charge, provided the Product is within its said warranty period. This warranty is in addition to other rights and remedies available to you under the law. Radio Systems goods come with guarantees that cannot be excluded under the Australia Consumer Law. You are entitled to a replacement or refund for a major failure and for compensation for any other reasonably foreseeable loss or damage. You are also entitled to have the goods repaired or replaced if the goods fail to be of acceptable quality and the failure does not amount to a major failure.

Should you have any queries or require any further information, please contact our Customer Care Centre on 1800 786 608 (Australia) or 0800 543 054 (New Zealand).

Compliance

CE

This equipment complies with the EMC and Low Voltage Directives. Unauthorised changes or modifications to the Product that are not approved by Radio Systems Corporation may violate EU regulations, could void the user's authority to operate the equipment, and will void the warranty.

The Declaration of Conformity can be found at:
http://www.petsafe.net/customer-care/eu_docs.php.

ACMA

This device complies with the applicable EMC requirements specified by the ACMA (Australian Communications and Media Authority).

Important Recycling Advice

Please respect the Waste Electrical and Electronic Equipment regulations in your country. This equipment must be recycled. If you no longer require this equipment, do not place it in the normal municipal waste system. Please return it to where it was purchased in order that it can be placed in our recycling system. If this is not possible, please contact the Customer Care Centre for further information.

Terms of Use and Limitation of Liability

1. **Terms of Use**

Use of this Product is subject to your acceptance without modification of the terms, conditions and notices contained herein. Use of this Product implies acceptance of all such terms, conditions and notices. If you do not wish to accept these terms, conditions, and notices, please return the Product, unused, in its original packaging and at your own cost and risk to the relevant Customer Care Centre together with proof of purchase for a full refund.

2. **Proper Use**

If you are unsure whether this Product is appropriate for your pet, please consult your veterinarian or certified trainer prior to use. Proper use includes, without limitation, reviewing the entire Operating Guide and any specific safety information statements.

3. **No Unlawful or Prohibited Use**

This Product is designed for use with pets only. Using this Product in a way that is not intended could result in violation of Federal, State or local laws.

4. **Limitation of Liability**

In no event shall Radio Systems Corporation or any of its associated companies be liable for (i) any indirect, punitive, incidental, special or consequential damage and/or (ii) any loss or damages whatsoever arising out of or connected with the misuse of this Product. The Purchaser assumes all risks and liability from the use of this Product to the fullest extent permissible by law.

5. **Modification of Terms and Conditions**

Radio Systems Corporation reserves the right to change the terms, conditions and notices governing this Product from time to time. If such changes have been notified to you prior to your use of this Product, they shall be binding on you as if incorporated herein.

PetSafe®-tuotteet on suunniteltu sinun ja lemmikkisi suhteen parantamiseksi. Lisätietoja laajasta tuotevalikoimastamme, johon sisältyvät hallintajärjestelmät, koulutusjärjestelmät, Haukunestolaite, lemmikin ovet, Terveys ja hyvinvointi, jätehuolto sekä leikki ja haasta -tuotteet, on saatavilla verkkosivulta www.petsafe.net.

PetSafe® produkter är gjorda för att förbättra relationen mellan dig och ditt husdjur. Om du vill veta mer om vårt breda produktutbud, som omfattar begränsningssystem, dressyrssystem, Skallbegränsare, Husdjursdörrar, hälsa och välbefinnande, spillningshantering samt produkter för lekar och utmaningar kan du besöka www.petsafe.net.

PetSafe®-produktene er laget for å forsterke forholdet mellom deg og kjæledyret ditt. Hvis du vil lære mer om vårt omfattende produkttilbud, som inkluderer Innhengningssystemer, dressursystemer, bjeffekontroll, Kjæledyrluker, helse og velvære og Lek og utfordre, kan du se www.petsafe.net.

PetSafe® produkterne er designet til at forbedre forholdet mellem dig og dit kæledyr. For at få mere at vide om vores omfattende produktsortiment, der inkluderer indhegningssystemer, træningssystemer, gøkontrol, Kæledyrets lemme, produkter til sundhed og velbefindende, affaldshåndtering samt leg og udfordring, er du velkommen til at besøge www.petsafe.net.

Продукция PetSafe® создается, чтобы улучшить ваши взаимоотношения с домашним животным. Дополнительные сведения о нашем обширном ассортименте продукции, такой как электронные изгороди, системы дрессировки, контроля лая, дверцы для домашних животных, такой как системы ограничения зоны, продукты для уборки фекалий, а также игры и головоломки для животных, см. на веб-сайте www.petsafe.net.

PetSafe® products are designed to enhance the relationship between you and your pet. To learn more about our extensive product range which includes Containment Systems, Training Systems, Bark Control, Pet Doors, Health & Wellness, Waste Management and Play & Challenge products, please visit www.petsafe.net.

Radio Systems Corporation
10427 PetSafe Way
Knoxville, TN 37932
(865) 777-5404

Radio Systems PetSafe Europe Ltd.
2nd Floor, Elgee Building, Market Square
Dundalk, Co. Louth, Ireland
+353 (0) 76 829 0427

www.petsafe.net

400-1960-46/1

©2016 Radio Systems Corporation