

Rechargeable  
BC-200-22



Automatic  
Rechargeable  
**No-Bark  
Collar**



## STOP YOUR DOG'S ANNOYING BARKING

### System Includes:

- Waterproof receiver collar
- Rechargeable NiMH batteries in collar
- Easy-to-adjust nylon buckle collar
- Short and long contact points for varying coat lengths
- Complete operating instructions
- 3 year warranty

Rechargeable  
BC-200-22

# INNOTEK®

*Quicker Training. Better Dogs.*



## The safe, effective way to stop excessive barking

Auto-Set feature automatically adapts to your dog's bark.

The more he barks, the higher the correction. As he learns to bark less frequently, the No-Bark Collar stops at the level just right for your dog. This exclusive patented Innotek® technology delivers immediate, effective stimulation for your dog, and is fair to him by recognizing good behavior.



NOTICE: Read the Operating Guide. DO NOT attach a leash to the Bark Control Collar. You may put a separate non-metallic collar on your dog's neck or use a harness for attaching a leash while using this collar. NEVER leave the collar on your dog for more than 12 consecutive hours.

Radio Systems® Corporation  
10427 Electric Ave.  
Knoxville, TN 37932 USA  
865-777-5404  
[www.innotek.net](http://www.innotek.net)  
[www.petsafe.net](http://www.petsafe.net)

Made in China.  
Covered by U.S. Patent 5,927,233.  
Covered by Australian patent 2005244199.  
Other patents pending.

414-414/1

BC-200-22



© 2010 Radio Systems Corporation

Thank you for choosing Innotek®. Through consistent use of our products, you can have a better behaved dog in less time than with other training tools. If you have any questions, please contact the Customer Care Centre. For a listing of Customer Care Centre telephone numbers, visit our website at [www.innotek.net](http://www.innotek.net).

To get the most protection out of your warranty, please register your product within 30 days at [www.innotek.net](http://www.innotek.net). By registering, and keeping your receipt, you will enjoy the product's full warranty and, should you ever need to call the Customer Care Centre, we will be able to help you faster. Most importantly, Innotek® will never give or sell your valuable information to anyone.

---

## Compliance

This device complies with the applicable EMC requirements specified by the ACMA (Australian Communications and Media Authority).



## Battery Disposal

Separate collection of spent batteries is required in many regions; check the regulations in your area before discarding spent batteries. This device operates on 1 battery of the type Nickel Metal Hydride (NiMH) with a 2.4 Volt, 250 mAH capacity. At the end of the product life, please contact one of our Customer Care Centres to receive instructions on proper disposal of the unit. Please do not dispose of the unit in household or municipal waste. For a listing of Customer Care Centre telephone numbers in your area, visit our website at [www.petsafe.net](http://www.petsafe.net).

<b>⚠ WARNING</b> RISK OF EXPLOSION IF BATTERY IS REPLACED BY AN INCORRECT TYPE. DISPOSE OF USED BATTERIES ACCORDING TO THE INSTRUCTIONS.
--



## Important Recycling Advise

Please respect the Waste Electrical and Electronic Equipment regulations in your country. This equipment must be recycled. If you no longer require this equipment, do not place it in the normal municipal waste system. Please return it to where it was purchased in order that it can be placed in our recycling system. If this is not possible, please contact the Customer Care Centre for further information.

Radio Systems® Corporation  
10427 Electric Ave.  
Knoxville, TN 37932 USA  
865-777-5404  
[www.petsafe.net](http://www.petsafe.net)



[www.innotek.net](http://www.innotek.net)

# Quick Start

## Step 1

### Adjust the Collar Strap

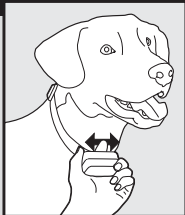

Place receiver collar on your dog with the receiver hanging directly beneath your dog's neck. Adjust the collar securely so that the contact points touch the skin of your dog's neck. Make sure the collar is not so tight as to cause discomfort. When the collar is properly adjusted, you should be able to place one finger between a contact point and the dog's skin. If your dog has a small neck size, you may wish to trim the excess strap length.

## Step 2

### Power Up

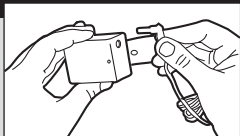

Charge the collar for 14-16 hours. Be sure to cover the charge jack with the gray plug when done.

## Step 3

### Using the Collar

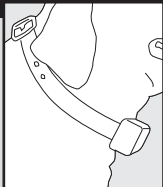

The collar is activated when the unit is charged. Simply put the collar on your dog and enjoy the peace and quiet. Innotek® Auto-Set feature will do all the work.

# BC-200-22 No-Bark Collar

## Your Dog's First Session

Monitor your dog during his first session. This is when he will learn what the collar means. Dogs learn at different speeds. It may take several barks or even several sessions for your dog to reduce his barking. Don't worry – the Auto-Set feature starts at the lowest level and will adjust to the right level to motivate your dog to stop barking. The collar will remember the correct level between uses.

## Resetting the Collar

The BC-200-22 resets to the lowest level each time it is charged. You may also reset the collar by recharging for as little as one minute.

## Testing the Collar

You may wish to test the collar from time to time. To test the collar, gently rub the contact points on a hard non-glass surface like a tabletop. A solid red LED indicates that the unit is functioning properly. Only when certain the collar is working properly should you place the collar on your dog.

## Troubleshooting

If the collar appears not to be working, try the following:

- Adjust the collar strap to fit
- Recharge the battery
- Check that the contact points are tightly screwed into the receiver
- Ensure that the contact points are touching the dog's skin. If your dog has a long or thick coat, you have two options to ensure contact: either trim the hair around the contact points or switch to the longer contact points included with your system.

**CAUTION** You may need to trim the hair in the area of the contact points. Never shave the dog's neck; this may lead to a rash or infection.

## Components

The BC-200-22 has a waterproof collar that can be submerged in water during a dog's normal activities; do not place in a dishwasher.

Two sets of contact points are included so you can choose what's right for your dog's coat.

The BC-200-22 is powered by a rechargeable NiMH battery. When the battery is low and needs to be charged, a red light will flash once every five seconds. The red light will glow steadily while being charged.

## IMPORTANT ADVICE

1. Read the complete manual and follow all directions. If you have any questions, please call the Customer Care Centre.
2. This device is intended for use only on dogs. Never attempt to use it for any purpose not described in this manual.
3. An electronic collar should only be used under close supervision by the dog's owner.  
**KEEP OUT OF REACH OF CHILDREN.**
4. Never perform set-up procedures while the collar is on your dog.
5. The proper fit and placement of your receiver collar is important for effective training. The contact points must have direct contact with your pet's skin on the underside of his neck.

**CAUTION** Please read and follow the instructions in this manual. Proper fit of the collar is important. A collar worn for too long or made too tight on the pet's neck may cause skin damage. This is called bed sores; it is also called decubitus ulcers or pressure necrosis.

- Avoid leaving the collar on the dog for more than 12 hours per day.
- When possible reposition the collar on the pet's neck every 1 to 2 hours.
- Check the fit to prevent excessive pressure; follow the instructions in this manual.
- Never connect a lead to the electronic collar; it will cause excessive pressure on the contacts.
- When using a separate collar for a lead, don't put pressure on the electronic collar.
- Wash the dog's neck area and the contacts of the collar weekly with a damp cloth.
- Examine the contact area daily for signs of a rash or a sore.
- If a rash or sore is found, discontinue use of the collar until the skin has healed.
- If the condition persists beyond 48 hours, see your veterinarian.

For additional information on bed sores and pressure necrosis, please visit our website.

These steps will help keep your pet safe and comfortable. Millions of pets are comfortable while they wear stainless steel contacts. Some pets are sensitive to contact pressure. You may find after some time that your pet is very tolerant of the collar. If so, you may relax some of these precautions. It is important to continue daily checks of the contact area. If redness or sores are found, discontinue use until the skin has fully healed.

6. Always use the rubber insulators between the collar strap and contact points to provide insulation in damp conditions.
7. Do not attach a lead or tags to the No-Bark Collar. You may put a separate non-metallic collar on your dog's neck and attach a lead or tags. Be sure the extra collar does not interfere with the contact points.
8. Do not attempt to dismantle or repair any components of this system; doing so will void the warranty in full. The computerized circuitry should be serviced only by an authorized expert.
9. Realize that because dogs have unique temperaments, there is no way of knowing how your dog will react to the introduction of a No-Bark Collar system. For the safety of your dog, a long lead should be used during initial training so you have control of the situation.

**⚠WARNING** **Not for use with aggressive dogs.** Do not use this product if your dog is aggressive or if your dog is prone to aggressive behaviour. Aggressive dogs can cause severe injury. If you are not sure that this product is right for your dog, please talk to your veterinarian or a certified trainer.

Proper use includes reviewing the entire Guide provided with your Product and any specific Caution statements.

## Explanation of Attention Words and Symbols used in this guide



This is the safety alert symbol. It is used to alert you to potential personal injury hazards. Obey all safety messages that follow this symbol to avoid possible injury or death.

### **⚠ WARNING**

WARNING indicates a hazardous situation which, if not avoided, could result in death or serious injury.

### **CAUTION**

CAUTION, used without the safety alert symbol, indicates a hazardous situation which, if not avoided, could result in harm to your dog.

---

## Terms of Use and Limitation of Liability

### 1. Terms of Use

Use of this Product is subject to your acceptance without modification of the terms, conditions and notices contained herein. Use of this Product implies acceptance of all such terms, conditions and notices. If you do not wish to accept these terms, conditions, and notices, please return the Product, unused, in its original packaging and at your own cost and risk to the relevant Customer Care Centre together with proof of purchase for a full refund.

### 2. Proper Use

This Product is designed for use with pets where training is desired. The specific temperament or size/weight of your pet may not be suitable for this Product (please refer to this Operating Guide). Radio Systems® Corporation recommends that this Product is not used if your pet is aggressive and accepts no liability for determining suitability in individual cases. If you are unsure whether this Product is appropriate for your pet, please consult your veterinarian or certified trainer prior to use. Proper use includes, without limitation, reviewing the entire Operating Guide and any specific Caution statements.

### 3. No Unlawful or Prohibited Use

This Product is designed for use with pets only. This pet training device is not intended to harm, injure or provoke. Using this Product in a way that is not intended could result in violation of Federal, State or local laws.

### 4. Limitation of Liability

In no event shall Radio Systems® Corporation or any of its associated companies be liable for (i) any indirect, punitive, incidental, special or consequential damage and/or (ii) any loss or damages whatsoever arising out of or connected with the misuse of this Product. The Purchaser assumes all risks and liability from the use of this Product to the fullest extent permissible by law. For the avoidance of doubt, nothing in this clause 4 shall limit Radio Systems® Corporation's liability for human death or personal injury or fraud or fraudulent misrepresentation.

### 5. Modification of Terms and Conditions

Radio Systems® Corporation reserves the right to change the terms, conditions and notices governing this Product from time to time. If such changes have been notified to you prior to your use of this Product, they shall be binding on you as if incorporated herein.