

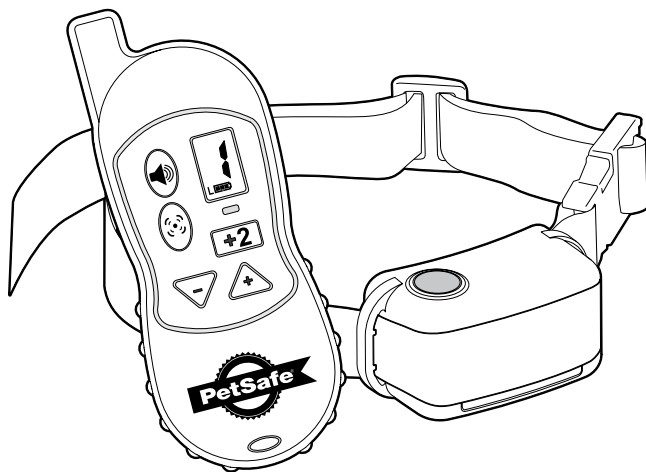

protect. teach. **love.**™

Vibration Remote Trainer

operating and training guide



Model Number
PDT00-14678

PLEASE READ THIS ENTIRE GUIDE BEFORE BEGINNING

IMPORTANT SAFETY INFORMATION

Explanation of Attention Words and Symbols used in this guide



This is the safety alert symbol. It is used to alert you to potential personal injury hazards. Obey all safety messages that follow this symbol to avoid possible injury or death.

⚠ WARNING

WARNING indicates a hazardous situation which, if not avoided, could result in death or serious injury.

⚠ CAUTION

CAUTION, used with the safety alert symbol, indicates a hazardous situation which, if not avoided, could result in minor or moderate injury.

CAUTION

CAUTION, used without the safety alert symbol, indicates a hazardous situation which, if not avoided, could result in harm to your pet.

⚠ WARNING

- **Risk of explosion.** Do not short circuit, mix old and new batteries, dispose of in fire, or expose to water. When batteries are stored or disposed, they must be protected from shorting. Dispose of used batteries properly.
- **Not for use with aggressive dogs.** Do not use this product if your dog is prone to aggressive behavior. Aggressive dogs can cause severe injury or death to their owners and others. If you are not sure that this product is right for your dog, please talk to your veterinarian or a certified trainer.

⚠ CAUTION

- **The PetSafe® Vibration Remote Trainer is not a toy.** Keep away from the reach of children. Use it only for its training purpose.
- **Safety during on-leash training.** It is vitally important that you and your dog remain safe while learning during on-leash training. Your dog should be on a strong leash, long enough for him to attempt to chase an object, but short enough for him not to reach a road or other unsafe area. You must also be physically strong enough to restrain your dog when he tries to chase.

CAUTION

Risk of skin damage. Please read and follow the instructions in this manual. Proper fit of the collar is important. A collar worn for too long or made too tight on the pet's neck may cause skin damage. Ranging from redness to pressure ulcers; this condition is commonly known as bed sores.

- Avoid leaving the collar on the dog for more than 12 hours per day.
- When possible reposition the collar on the pet's neck every 1 to 2 hours.
- Check the fit to prevent excessive pressure; follow the instructions in this manual.
- Never connect a lead to the electronic collar; it will cause excessive pressure on the contacts.
- When using a separate collar for a lead, don't put pressure on the electronic collar.
- Wash the dog's neck area and the contacts of the collar weekly with a damp cloth.
- Examine the contact area daily for signs of a rash or a sore.
- If a rash or sore is found, discontinue use of the collar until the skin has healed.
- If the condition persists beyond 48 hours, see your veterinarian.
- For additional information on bed sores and pressure necrosis, please visit our website.

These steps will help keep your pet secure and comfortable. Some pets are sensitive to contact pressure. You may find after some time that your pet is very tolerant of the collar. If so, you may relax some of these precautions. It is important to continue daily checks of the contact area. If redness or sores are found, discontinue use until the skin has fully healed.

The PetSafe® Vibration Remote Trainer must be used only on healthy dogs. We recommend that you take your dog to a veterinarian before using the collar if he is not in good health.

Thank you for choosing the PetSafe® brand. You and your pet deserve a companionship that includes memorable moments and a shared understanding together. Our products and training tools enhance the relationship between pets and their owners. If you have any questions about our products or training your pet, please visit our website at www.petsafe.net or contact our Customer Care Center at 1-800-732-2677.

To get the most protection out of your warranty, please register your product within 30 days at www.petsafe.net. By registering and keeping your receipt, you will enjoy the product's full warranty and should you ever need to call the Customer Care Center, we will be able to help you faster. Most importantly, PetSafe® will never give or sell your valuable information to anyone. Complete warranty information is available online at www.petsafe.net.

Table of Contents

Components	5
Other Items You May Need	5
How the System Works	6
Features	6
Key Definitions	7
Operating Guide	
Prepare the Handheld Remote	8
Prepare the Receiver Collar	10
Fit the Receiver Collar	11
To Pair the Handheld Remote and Receiver Collar	13
Training Guide	
Test the Remote Trainer	14
General Tips	14
Training Your Pet with Tone	15
Find the Best Vibration Level for Your Pet	15
+2 Boost	16
Dog Training Recommendations	16
Teaching Basic Obedience	17
The "Sit" Command	17
The "Recall" Command	18
The "Stay" Command	18
Eliminating Unwanted Behavior	19
Jumping Up	19
Digging	20
Chasing	21
Trash Raiding	22
Frequently Asked Questions	23
Troubleshooting	24

Customer Care International	24
Battery Disposal	25
Perchlorate Battery	25
Compliance	25
Terms of Use and Limitation of Liability	26
Warranty	26

Components

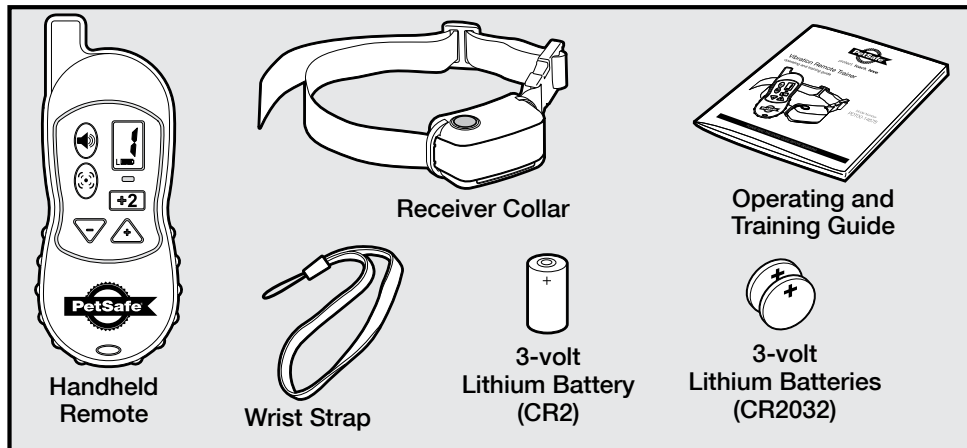

Other Items You May Need

- Small Phillips screwdriver
- Pliers
- Scissors
- Lighter
- Non-metallic collar and 10-foot leash

How the System Works

Now you can experience the difference a Remote Trainer can make. Spend less time training and more time enjoying your dog. The Petsafe® Vibration Remote Trainer assists you in controlling your pet without a leash in a range of up to 100 yards. The Remote Trainer is comfortable for your pet and easy to use with 16 levels of continuous Vibration (8 low levels and 8 high levels). The Vibration Remote Trainer has an advanced Digital Display that tells you exactly what level of vibration you are using.

At the push of a button, your Handheld Remote sends a signal activating your dog's Receiver Collar. The Vibration is delivered from one of the two Vibration Points. Using the Remote Trainer is a great method of communicating with your dog and it is capable of teaching all the customary commands.

Important: The Vibration Remote Trainer has a range up to 100 yards. Hold the Handheld Remote in a horizontal position away from your body to achieve optimum range. Terrain, weather, vegetation, transmission from other radio devices, and other factors will affect the maximum range.



Features

- Range up to 100 yards
- 16 levels of Vibration (8 low levels and 8 high levels)
- +2 Boost instantly increases the current Vibration Level by 2
- Tone Button reinforces good behavior
- Easy to read Digital Display on Handheld Remote
- Water-resistant Receiver Collar

Key Definitions

Handheld Remote: Transmits the signal to the Receiver Collar.

Tone Button (Green): Sends an audible tone to the collar. No Vibration is delivered.

Vibration Button (Blue): Delivers Vibration through the Vibration Points on the Receiver Collar at the level shown on the Digital Display. A safety time-out will be triggered if the button is held for more than 10 consecutive seconds. The safety time-out will end when the button is released.

+2 Boost Button (Red): Adds a boost 2 levels above the currently selected Vibration Level. Can not exceed the 8 High Level.

Vibration Down Button (-): Decreases Vibration Level by 1.

Vibration Up Button (+): Increases Vibration Level by 1.

Digital Display: Indicates Vibration Level, pairing mode and battery status. See “Prepare the Handheld Remote” section for more details.

LED (Handheld Remote): 3 colors indicate which function the Handheld Remote is currently performing.

Green LED: Indicates Tone is being transmitted.

Red LED: Indicates Vibration is being transmitted. Also indicates low battery.

Orange LED: Indicates pairing command is being transmitted.

Receiver Collar: Delivers Vibration or Tone on a signal from the Handheld Remote. It is water-resistant.

On/Off Button: Momentarily pressing and holding this button turns the Receiver Collar on and off.

Vibration Points: Deliver Vibration to your pet from the Handheld Remote.

LED (Receiver Collar): Indicates that a button is pressed and also serves as a low-battery indicator.

Red LED: Indicates low battery and when Vibration Button is pressed.

Green LED: Indicates good battery and when Tone Button is pressed. Also indicates when Pairing Mode is complete.

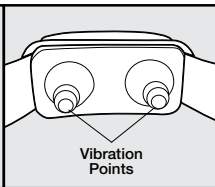
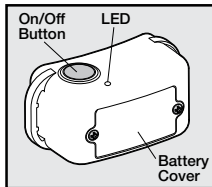
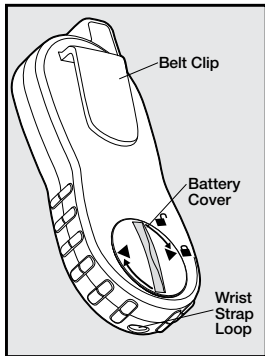
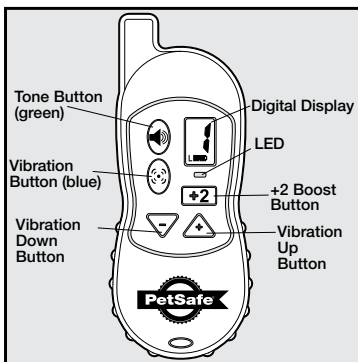

OPERATING GUIDE

STEP 1

Prepare the Handheld Remote

To Insert and Remove the Battery

1. To remove, use a coin and turn the Battery Cover counter-clockwise until the right triangle aligns with the unlock symbol on the Handheld Remote housing (1A).
2. Install two (2), 3-volt (CR2032) batteries positive (+) side up (1B).
3. To replace the Battery Cover, align the right triangle with the unlock symbol, press down and turn clockwise (1C) so that the right triangle aligns with the lock symbol on the Handheld Remote housing.

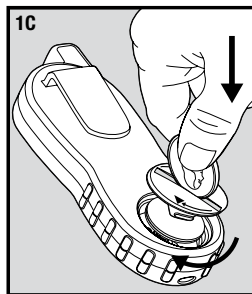
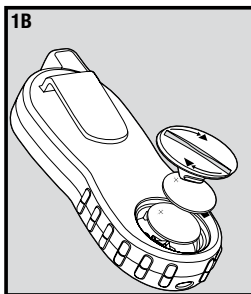
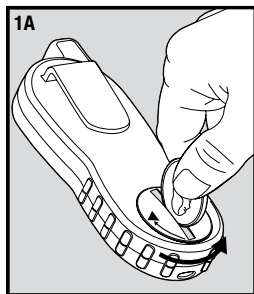

To verify the batteries are inserted correctly





1. Press any button on the Handheld Remote.
2. The Digital Display should activate showing the current stimulation level.
3. If the Digital Display doesn't activate, you may have inserted the batteries backwards. Try taking them out and turning them over, ensuring that the (+) side is up.
4. If the Digital Display still does not activate, contact the Customer Care Center.

⚠ WARNING

Risk of explosion if battery is replaced by an incorrect type. Do not short circuit, mix old and new batteries, dispose of in fire, or expose to water. When batteries are stored or disposed, they must be protected from shorting. Dispose of used batteries properly.

Handheld Remote Digital Display

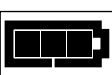
The Digital Display stays on for approximately 30 seconds after a button press. After 30 seconds with no button press, the display shuts off and the Handheld Remote goes into battery conservation mode. Pressing any button will turn the display back on. The symbols on the Digital Display are explained below.

	L indicates low Vibration Levels ranging from 1-8, and appears in the lower left corner before the battery indicator.
	H indicates high Vibration Levels ranging from 1-8, and appears in the lower right corner after the battery indicator.
	The battery indicator provides constant awareness of your battery's power level. Divided into segments, 3 segments indicate high battery power, 2 segments indicate medium, 1 segment indicates low (replace soon) and no segments indicate critically low (replace immediately). <i>Note: Red LED will flash 3 times every 5 seconds to indicate low battery.</i>
	Indicates Handheld Remote is ready to pair with Receiver Collar. Press Vibration Down Button (–) through the Vibration Levels to display and begin pairing.

Handheld Remote LED – Function and Response

Button	Button Function	Handheld Remote LED Response
Tone Button (Green)	Delivers audible Tone to the Receiver Collar.	Green LED on for length of button press
Vibration Button (Blue)	Delivers Vibration to the Receiver Collar based on the current level shown on the Digital Display. A safety time-out will be triggered if the button is held for more than 10 consecutive seconds. The safety time-out will end when the button is released.	Red LED on for length of button press <i>Note: Red LED will also flash 3 times every 5 seconds to indicate low battery.</i>
+2 Boost Button (Red)	Delivers Vibration at 2 levels higher than the current setting. (Can not exceed level 8 High and will also time-out after button is held for 10 continuous seconds.)	Red LED on for length of button press
Tone and Vibration Buttons held simultaneously	Transmits Pairing command to the Receiver Collar when “P” is visible on the Digital Display.	Orange LED on for length of button press

STEP 2

Prepare the Receiver Collar

To Insert and Remove the Battery

1. Remove the screws with a small Phillips screwdriver, applying adequate pressure for the screwdriver head to fit snugly into the screw. Remove the Battery Cover (2A).
2. Install one (1), 3-volt (CR2) battery as shown (2B). Place the Battery Cover back into the Receiver Collar. *Note: Be sure the gasket on the inside rim of the Battery Cover is intact each time you replace it.*
3. Reinstall the screws. Do not over-tighten the screws.

Replacement batteries can be found at many retailers. Contact the Customer Care Center or visit our website at www.petsafe.net for a list of common retailers.

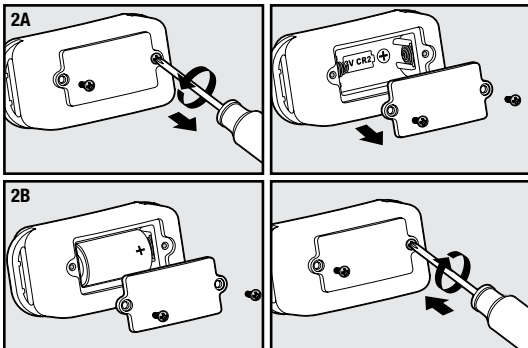

WARNING

Risk of explosion if battery is replaced by an incorrect type. Do not short circuit, mix old and new batteries, dispose of in fire, or expose to water. When batteries are stored or disposed, they must be protected from shorting. Dispose of used batteries properly.

To Turn the Receiver Collar On

1. Press and hold the On/Off Button until the unit beeps and the Green LED light comes on. (This takes approximately one second.)
2. Release the On/Off Button. The Green LED will flash once every 5 seconds, indicating the Receiver Collar is on and ready to receive a signal from the Handheld Remote.

To Turn the Receiver Collar Off

1. Press and hold the On/Off Button until the unit beeps and the LED light shuts off. (This takes approximately 3 seconds.)
2. Release the On/Off Button. *Note: To extend the life of the batteries, turn the Receiver Collar off when it is not in use.*

Important: If the Receiver Collar is left on continuously, the maximum battery life will be two weeks.

Receiver Collar LED – Function and Response

Receiver Collar Function	Green LED Response
Power on	Flashes once and beeps low to high
Normal operation - Good battery	1 flash every 5 seconds
Training Tone	On length of button press
Pairing Complete	Flashes 5 times

Receiver Collar Function	Red LED Response
Power off	On for 3 seconds
Normal operation - Low battery	3 flashes every 5 seconds
Vibration	On length of button press

STEP 3

Fit the Receiver Collar

Important: The proper fit and placement of your Receiver Collar is important for effective operation. The Vibration Points must have direct contact with your dog's skin on the underside of his neck.

To assure a proper fit, please follow these steps:

1. Make sure that the Receiver Collar is turned off.
2. Start with your dog standing comfortably (3A).
3. Place the Receiver Collar on your dog's neck close to the ears. Center the Vibration Points underneath your dog's neck, touching the skin (3B). *Note: It is sometimes necessary to trim the hair around the Vibration Points to make sure that contact is consistent.*

CAUTION Do not shave the pet's neck as this may increase the risk of skin irritation.

4. Check the tightness of the Receiver Collar by inserting one finger between the collar and your dog's neck (3C). The fit should be snug but not constricting.
5. Allow your dog to wear the Receiver Collar for several minutes then recheck the fit. Check the fit again as your dog becomes more comfortable with the Receiver Collar.

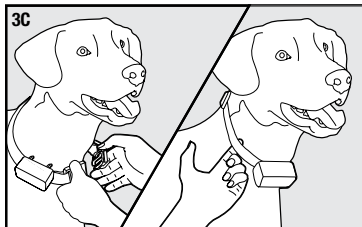
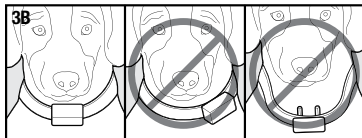
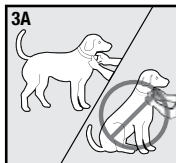

6. Trim the collar as follows: **(3D)**

- Mark the desired length of the collar with a pen. Allow for growth if your dog is young or grows a thick winter coat.
- Remove the Receiver Collar from your dog and cut off excess.
- Before placing the Receiver Collar back onto your dog, seal the edge of the cut collar by applying a flame along the frayed edge.

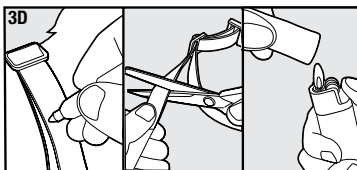

CAUTION

The Receiver Collar should not be worn for more than 12 hours out of every 24-hour period. Leaving the Receiver Collar on too long could lead to skin irritation. Please refer to page 2 for additional information.

To Re-Thread the Collar

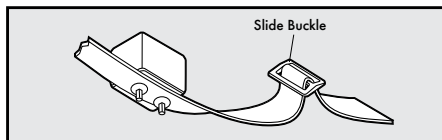

The slide buckle prevents the collar from becoming loose around your pet's neck.

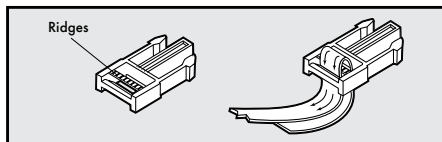

The ridges must be facing up; the collar will slip if it is not properly threaded.

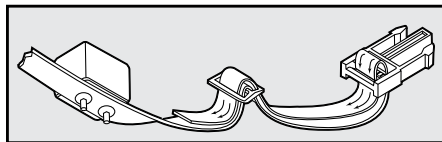

STEP 4

To Pair the Handheld Remote and Receiver Collar

If your Receiver Collar does not beep when the Tone Button of the Handheld Remote is pressed, or if the Receiver Collar is not responding to the Handheld Remote, follow these steps to pair:

1. Start with the Receiver Collar off your pet and powered off.
2. Press and hold the On/Off Button until the Green LED light shuts off. When the Green LED shuts off, release the On/Off Button and the Receiver Collar LED will flash green.
3. Place the Handheld Remote into pairing mode by pressing the Vibration Down Button (-) until the Digital Display shows "P".
4. Press the Tone and Vibration Buttons simultaneously (the Orange LED should be lit) until the Receiver Collar flashes the Green LED 5 times, indicating it has learned the Handheld Remote ID.
5. Change the level to 1 Low by pressing the Vibration Up Button (+) on the Handheld Remote and then press the Tone Button. The Receiver Collar will emit a tone, verifying that it is paired with the Handheld Remote.
6. If the Receiver Collar does not respond, please contact the Customer Care Center.

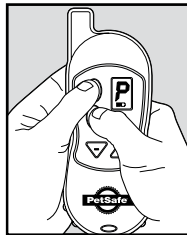

TRAINING GUIDE

Test the Remote Trainer

We recommend you experience first-hand how the Remote Trainer functions. Always begin at the lowest level and increase the intensity up to your personal comfort level.

1. Place your fingers on both Vibration Points of the Receiver Collar.
 2. Hold the Handheld Remote approximately 2 feet from the Receiver Collar and press the Vibration Up Button (+) to show Level 1 on the Digital Display. Press the Vibration Button (Blue). At this level you may not feel the Vibration Stimulation. **Note: An automatic safety time-out will be triggered if any Vibration Button is held for more than 10 seconds. Once released, the Vibration Button resets to normal functionality.**
 3. Increase the intensity until the sensation begins to feel uncomfortable.
-

General Tips

Introducing the Remote Trainer: Introduce your PetSafe® Receiver Collar when your dog graduates from puppy stage and understands basic obedience commands. PetSafe® Receiver Collars should only be used with pets who are over 4 to 6 months of age.

Avoiding a “Collar Wise” dog: Try to avoid letting your dog become “collar wise”, obeying only when wearing the PetSafe® Receiver Collar. Similarly, avoid letting the dog learn to obey only when seeing the Handheld Remote in your hand. This is easy to prevent (see “Remain the Leader” in the “Dog Training Recommendations” section).

Training Sessions & Determining Stimulation Levels: Keep your training sessions short and watch your dog’s reaction - your pet will tell you what level of Vibration is appropriate to use and when to release the button. Please refer to “Find the Best Vibration Level for Your Pet” for additional information.

Stopping Unwanted Behavior: When stopping unwanted behavior, it is suggested to use higher levels of Vibration - the pet should be convinced that his unacceptable actions (not you) caused the annoying sensation to happen.

Dogs First Learn One Command: Focus on learning one command before moving on to another. When teaching a command like “heel”, “come”, “sit”, or “down”, many trainers recommend using low levels of Vibration. The dog quickly learns to turn off or completely avoid the unpleasant sensation.

Reinforcing Known Commands: To reinforce commands the dog already knows, it is suggested to use medium Vibration levels. This teaches the dog to respect instructions by always listening and obeying.

Note: Using praise or treats to reward the correct response is great for encouraging the dog, but it is suggested you and your family members always remain the dog’s leader.

⚠WARNING

Never use the Remote Trainer to correct or eliminate any form of aggressive behavior. We recommend you contact your local veterinarian or professional trainer to determine if your pet might be aggressive.

Training Your Pet with Tone

Note: Other pets in hearing range will be affected by the training tones. Therefore, training sessions should be conducted out of hearing range of other pets.

Before using the Trainer to correct your pet, spend 10 to 15 minutes per day for 2 or 3 days helping him create the association of the Tone with reward and praise. To accomplish this:

1. Push the Tone Button (Green) for 2 consecutive seconds.
2. Release the button and immediately reward your pet with verbal praise, petting, or a small food reward. Spend 3 to 5 seconds on your rewarding.
3. Wait a few minutes and repeat holding the Tone Button for 2 seconds following with praise.

Vary the reward to prevent your pet from anticipating a specific type. This stage of training is complete when your pet obviously anticipates a reward when he hears the Tone.

Find the Best Vibration Level for Your Pet

Important: Always start at the lowest level and work your way up.

The Vibration Remote Trainer has 8 Low and 8 High Vibration Levels. This allows you to choose the Vibration Level that is best for your pet.

Once you have placed the Receiver Collar on your pet, it is time to find the Vibration Level that is best for him. This is called the Recognition Level.

A slight change in your pet's behavior, such as looking around in curiosity, scratching at his collar, or flicking his ears, indicates the Recognition Level that is best for him.

Follow the steps below to find your pet's Recognition Level:

1. Starting at Level 1 Low on the Digital Display, press the Vibration Button (blue) continuously for 1 to 2 seconds.
2. If your pet shows no reaction, repeat the same Vibration Level several times before moving up to the next level.
3. YOUR PET SHOULD NOT VOCALIZE OR PANIC WHEN RECEIVING VIBRATION. IF THIS HAPPENS, THE LEVEL IS TOO HIGH AND YOU NEED TO GO BACK TO THE PREVIOUS LEVEL AND REPEAT THE PROCESS.
4. Move up through the Vibration Levels until your pet reliably responds to that level.
5. If your pet continues to show no response at Level 8 High, check the fit of the Receiver Collar. If your pet has long or thick hair, your pet's hair will need to be trimmed around the Vibration Points.

CAUTION Do not shave the pet's neck as this may increase the risk of skin irritation.
--

If, after completing all of these steps, your dog still does not indicate he is feeling the Vibration, please contact Customer Care Center or visit our website at www.petsafe.net.

+2 Boost

Pressing the +2 Boost Button (Red) sends a signal to the Receiver Collar to issue a Vibration that is 2 levels higher than the currently selected level. For example, if the Vibration Level is set at Level 2 Low, pressing the +2 Boost Button will stimulate at Level 4 Low. *Note: The system can not exceed the 8 High Vibration Level.*

Dog Training Recommendations

When Training Begins: Training starts the moment you bring your puppy home. While your dog will not be ready for the PetSafe® products until he has matured, you should begin basic training immediately.

Remain the Leader: Stop your dog from becoming “collar wise”. An easy solution known as “Collar Conditioning” will help prevent the dog from listening only when wearing the Receiver Collar and disobeying when he is not wearing it. First, fit the Receiver Collar on your dog. Second, immediately take your dog outside or do something he enjoys; don’t activate the Receiver Collar. Let the dog wear it during non-training sessions. Your dog should believe wearing the Receiver Collar can also result in having fun. It should not be perceived as punishment. Place the Receiver Collar on and off the dog at various times for short or longer periods to make wearing it a normal routine. Similarly, don’t let the dog learn to obey only when he sees the Handheld Remote. Also carry the Handheld Remote, but don’t use it all the time. How long should this process take? Professional trainers’ opinions vary from a few days to a couple of weeks.

Focus on the Dog: Professional trainers’ opinions vary on some issues, but all users of remote training systems strongly recommend watching your dog, not the Handheld Remote, when training. PetSafe® products are specifically designed to make this task simple. It is easy and you should find the point where your dog first perceives the Vibration. See “Find the Best Vibration Level for Your Pet”.

“Good Dog” in the Home or Outside: Stopping unwanted behavior is easy using the PetSafe® Remote Trainers. Your dog can be good in and out of the house. Remember to be fair to the dog and remove temptation whenever possible.

Be Consistent and Responsible: Use the Remote Trainer every time your dog misbehaves. Only let responsible family members use the Remote Trainer. It is not a toy!

Learn how to use your PetSafe® Remote Trainer to teach your dog the following basic commands:

- Sit
- Come
- Stay

And eliminate the following unwanted behaviors:

- Jumping Up
- Digging
- Chasing
- Trash Raiding

Teaching Basic Obedience

The “Sit” Command

1. Put a separate, non-metallic collar on your pet’s neck ABOVE the Receiver Collar, and attach a 10-foot leash. *Note: Be sure the extra collar does not put pressure on the Vibration Points.*
2. Hold the leash and the Handheld Remote in one hand. Keep your other hand free to guide your pet into a “Sit” position.
3. Press and hold the Vibration Button, starting at your pet’s Recognition Level.
4. Immediately give the “Sit” command while continuing to hold the Vibration Button.
5. Release the Vibration Button as soon as your pet is in position, and praise him.
6. Release your pet from the “Sit” command and play.
7. Repeat Steps 2 through 6.

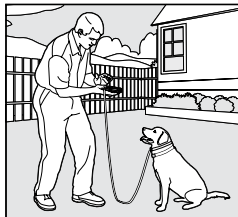
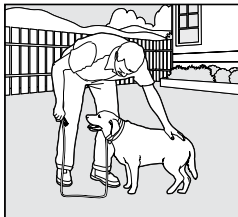

Note: If your pet breaks the “Sit” command, repeat steps 3 through 6. Keep your pet close to you while teaching the “Sit” command.

The “Recall” Command

1. Put a separate, non-metallic collar on your pet's neck ABOVE the Receiver Collar, and attach a 10-foot leash. *Note: Be sure the extra collar does not put pressure on the Vibration Points.*
2. Hold your leash in one hand and the Handheld Remote in the other.
3. Wait for your pet to walk away from you. Using the Recognition Level for your pet, press and hold the Vibration Button on your Handheld Remote.
4. Immediately give the command “Come” while continuing to hold the Vibration Button.
5. Using the leash, gently guide your pet toward you until he begins to come in your direction.
6. Immediately release the Vibration Button as soon as your pet steps towards you, and praise him enthusiastically.
7. Quickly move backwards as your pet begins to come back to you, praising him the entire time.
8. Praise your pet when he returns to you.
9. Repeat Steps 3 through 8.
10. Once your pet responds readily to the “Come” command several times, back away from him without giving a command. When your pet turns toward you, give the command “Come” (WITHOUT VIBRATION) and praise him while you continue to back up. Praise your pet when he returns to you.
11. Use your leash to prevent your pet from running past you. If your pet manages to run past you, repeat Steps 3 through 8.

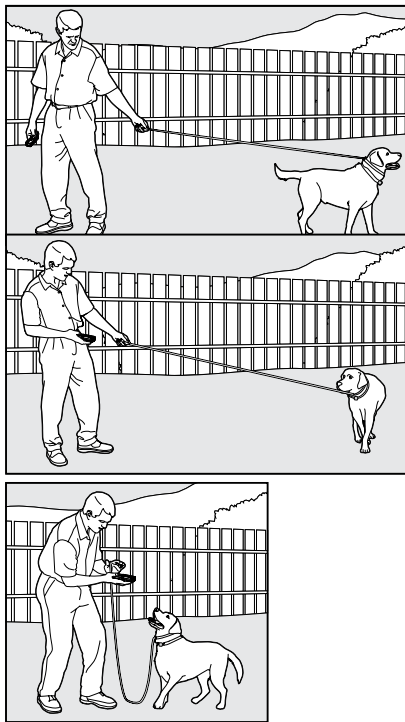

The “Stay” Command

1. Put a separate, non-metallic collar on your pet's neck ABOVE the Receiver Collar, and attach a 10-foot leash. *Note: Be sure the extra collar does not put pressure on the Vibration Points.*
2. Visibly identify a designated area where you want your pet to sit by placing his bed or a large piece of cloth on the ground.
3. After identifying a place, put your pet in that area. Hold your leash in one hand and the Handheld Remote in the other.

4. Staying within approximately 3 feet, walk around the perimeter of the designated area. Do not say anything to your pet.
5. If your pet tries to leave that area, press and hold the Vibration Button while saying “Stay”, and if necessary, use the leash to guide your pet onto the designated area.
6. Immediately release the Vibration Button as soon as your pet returns to the area and praise him enthusiastically.
7. Once your pet has settled for a few seconds, release him and play calmly.
8. Repeat steps 1 through 5.

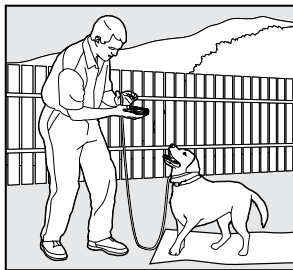
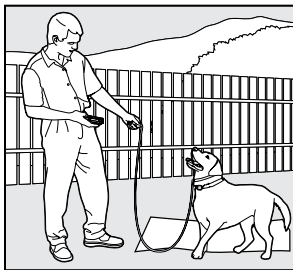

Eliminating Unwanted Behavior

Jumping Up

Pets typically jump up to get attention. If you do not want your pet to jump on you, then friends or members of the family should not encourage this behavior. That means every time your pet jumps on someone, he should be reprimanded or redirected to an alternate and acceptable behavior, for which he can receive praise.

Note: It is best if your pet first understands the “Sit” command.

1. Choose your pet’s Recognition Level.
2. As soon as your pet lifts his paws off the ground to jump on you, press the Vibration Button and give the command “Sit.”
3. Release the Vibration Button immediately once your pet is sitting, and verbally praise him.
4. If your pet ignores the Vibration, increase the level by 1.
5. Practice this exercise in several different areas and use different people for distractions.



Digging

It is important to first understand why your pet is digging. Many dogs, such as terriers, were bred to flush out prey, and digging is very innate to them. Other dogs may be digging to find a cool spot to lie down, or simply out of boredom. Your pet may no longer have the desire to dig if he is provided with the following:

- A cool, shaded area in which to lie down, and plenty of water.
- An alternate activity, such as a favorite toy.
- Plenty of play, exercise, and attention.
- A yard free from rodents or prey that he may be trying to flush out.

1. Choose the Vibration Level 1 higher than your pet's Recognition Level.
2. Place the Receiver Collar on your pet and wait at least 10 minutes before placing him in the yard. No other people or pets should be in the yard, as you do not want your pet to associate the Vibration Stimulation with anything other than his digging. Your pet must be securely fenced in or contained during training.
3. From a window or area where your pet cannot see you, wait until your pet begins to dig.
4. While your pet digs, press the Vibration Button and release it when he stops digging. Only press the button while your pet is in the act of digging, and do not say anything to him.
5. If your pet ignores the Vibration, increase the level by 1.
6. Continue to watch your pet, as he may choose another area to dig.
7. Do not allow your pet in the yard unsupervised until he has completely stopped digging.

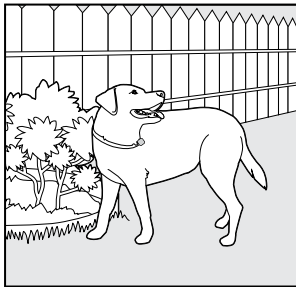
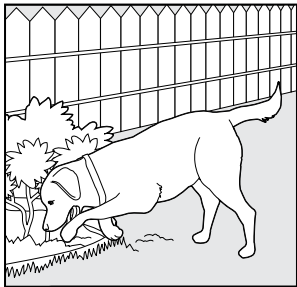
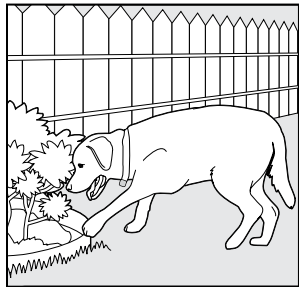

Chasing

Chasing is an instinctive behavior stimulated by moving objects. Some dogs have a particularly strong desire to chase that can put them in harm's way and leave you helpless. Never allow your dog off the leash or out of a contained area until he has learned the "Recall" command, regardless of the distraction. Be consistent and correct your dog every time he chases something.

CAUTION

It is vitally important that you and your dog remain safe while learning during on-leash training. Your dog should be on a strong leash, long enough for him to attempt to chase an object, but short enough for him not to reach a road or other unsafe area. You must also be physically strong enough to restrain your dog when he tries to chase.

1. If your dog has not learned the "Recall" command, keep a leash on him so you can physically stop him before he reaches the object he is chasing.
2. Choose the Vibration Level 1 higher than your dog's Recognition Level.
3. Set up a scenario where your dog is enticed to chase an object. Common items could be cars, motorcycles, bicycles, etc. (do not use toys).
4. When the object passes in front of your dog, make sure to hold the leash with a firm grip. As soon as your dog begins to chase the object, press and hold the Vibration Button until he stops.
5. When your dog stops chasing the object, immediately release the button, walk backwards and give the command "Come." Praise your dog as he comes to you.
6. Repeat the process until your dog stops chasing the object.

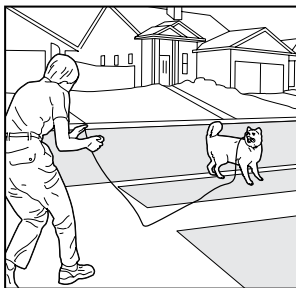
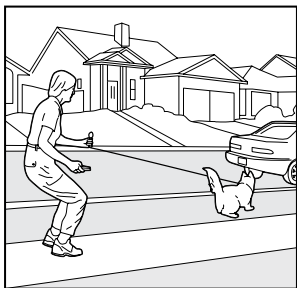
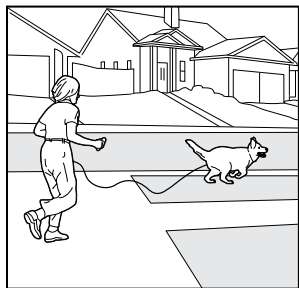

Trash Raiding

The easiest way to prevent trash raiding is to remove garbage and tempting food from your pet's environment. You can use the Vibration Remote Trainer to teach your pet to stay away from these items; however, you must be prepared to correct your pet every time he approaches them.

1. Choose the Vibration Level 1 higher than your pet's Recognition Level.
2. Pick a temptation for your pet and position yourself where he cannot see you.
3. While your pet's mouth is touching the temptation, press and hold the Vibration Button. Immediately release the button when your pet leaves the temptation.
4. Do not say anything, as you want your pet to associate the Vibration with his behavior, not you.
5. If your pet does not respond to the Vibration, increase the level by 1 and repeat the process.
6. Repeat this process in several different locations with different temptations.

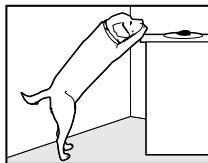
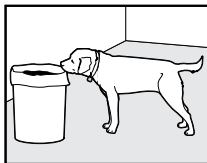

FREQUENTLY ASKED QUESTIONS

Is the Vibration safe for my pet?	<ul style="list-style-type: none">• While the Vibration is unpleasant, it is harmless to your pet. Electronic training devices require interaction and training from the owner to achieve desired results.
How old does my pet have to be before using the PetSafe® Vibration Remote Trainer?	<ul style="list-style-type: none">• Your pet should be able to recognize basic obedience commands such as “Sit” or “Stay”. Pets should be at least 6 months old before using the Trainer.
Once my pet is trained and has been obeying my commands, will he have to continue to wear the Receiver Collar?	<ul style="list-style-type: none">• Probably not. You may need to reinforce training with the Receiver Collar from time to time.
Will I get exactly 100 yards of range with the Remote Trainer?	<ul style="list-style-type: none">• The range of the Vibration Remote Trainer will vary according to terrain, weather, vegetation, as well as transmission from other radio devices. See “How the System Works” for tips on maximizing your range.
How long can I continuously deliver Vibration to my pet?	<ul style="list-style-type: none">• The maximum amount of time you can press the Vibration Button and deliver Vibration to your pet continuously is 10 seconds. After this, the Handheld Remote will time-out, and the Vibration Button must be released and pressed again.

TROUBLESHOOTING

My pet does not respond when I press a button.	<ul style="list-style-type: none">• Make sure the Receiver Collar has been turned on.• If your range has reduced from the first time you used the Remote Trainer, the battery(s) may be low in either the Handheld Remote or Receiver Collar.• Many factors can impact the amount of range you have with the Remote Trainer. For a list of these factors, see “How the System Works”.• Increase the Vibration Level. Refer to “Find the Best Vibration Level For Your Pet” for more information.• Make sure the Receiver Collar's Vibration Points are placed snugly against your pet's skin. Refer to “Fit the Receiver Collar” for more information.
The Receiver Collar will not turn on.	<ul style="list-style-type: none">• Check that one (1) 3-volt (CR2) battery has been installed properly. See “To Insert and Remove the Battery.”
The Receiver Collar is not responding to the Handheld Remote.	<ul style="list-style-type: none">• Verify the Receiver Collar is on.• If the LED does not come on when a button is pressed on the Handheld Remote, ensure that the batteries are inserted properly.• If the first two solutions did not resolve your problem, see “To Pair the Handheld Remote and the Receiver Collar.”

Customer Care International

USA & Canada - Tel: 800-732-2677

Monday - Friday 8 AM - 8 PM / Saturday 9 AM - 5 PM

Australia - Tel: 1800 786 608

Monday - Friday 7:30 AM - 5 PM

New Zealand - Tel: 0800 543 054

Monday - Friday 10:30 AM - 7 PM

This product has the benefit of a limited manufacturer's warranty. Details of the warranty applicable to this product and its terms can be found at www.petsafe.net and/or are available by sending a stamped addressed envelope to PetSafe® Ltd. Redthorn House, Unit 9, Chorley West Business Park, Ackhurst Road, Chorley, Lancashire PR7 1NL, United Kingdom.



Battery Disposal

Separate collection of spent batteries is required in many regions; check the regulations in your area before discarding spent batteries. At the end of the product life, please contact our Customer Care Center to receive instructions on proper disposal of the unit. Please do not dispose of the unit in household or municipal waste. For a listing of Customer Care Center telephone numbers in your area, visit our website at www.petsafe.net.

Perchlorate Battery

Perchlorate Material – special handling may apply.
See www.dtsc.ca.gov/hazardouswaste/perchlorate.

Compliance



This device complies with part 15 of the FCC Rules. Operation is subject to the following two conditions:

(1) This device may not cause harmful interference, and (2) this device must accept any interference received, including interference that may cause undesired operation.

CAUTION: Modification or changes to this equipment not expressly approved by Radio Systems Corporation® may void the user's authority to operate the equipment.

NOTE: This equipment has been tested and found to comply with the limits for a Class B digital device, pursuant to part 15 of the FCC Rules. These limits are designed to provide reasonable protection against harmful interference in a residential installation. This equipment generates, uses, and can radiate radio frequency energy and, if not installed and used in accordance with the instructions, may cause harmful interference to radio communications. However, there is no guarantee that interference will not occur in a specific installation. If interference does occur to radio or television reception, which can be determined by turning the equipment off and on, the user is encouraged to try to correct the interference by one or more of the following measures:

- Reorient or relocate the receiving antenna.
- Increase the separation between the equipment and the receiver.
- Connect the equipment to an outlet on a circuit different from that to which the receiver is connected.
- Consult customer care, the dealer, or an experienced radio/TV technician for help.

ACMA - Australia

This device complies with the applicable EMC requirements specified by the ACMA (Australian Communications and Media Authority).

Terms of Use and Limitation of Liability

1. Terms of Use

This Product is offered to you conditioned upon your acceptance without modification of the terms, conditions and notices contained herein. Usage of this product implies acceptance of all such terms, conditions, and notices.

2. Proper Use

This Product is designed for use with pets where training is desired. The specific temperament or size/weight of your pet may not be suitable for this Product (please refer to “How the System Works” in this Operating Guide). Radio Systems® Corporation recommends that this Product is not used if your pet is aggressive and accepts no liability for determining suitability in individual cases. If you are unsure whether this Product is appropriate for your pet, please consult your veterinarian or certified trainer prior to use. Proper use includes, without limitation, reviewing the entire Operating Guide and any specific Caution statements.

3. No Unlawful or Prohibited Use

This Product is designed for use with pets only. This pet training device is not intended to harm, injure, or provoke. Using this product in a way that is not intended could result in violation of Federal, State or local laws.

4. Limitation of Liability

In no event shall Radio Systems® Corporation be liable for any direct, indirect, punitive, incidental, special or consequential damages, or any damages whatsoever arising out of or connected with the use or misuse of this Product. Buyer assumes all risks and liability from the use of this Product.

5. Modification of Terms and Conditions

Radio Systems® Corporation reserves the right to change the terms, conditions and notices under which this Product is offered.

Warranty

One Year Non-Transferrable Limited Warranty

This Product has the benefit of a limited manufacturer's warranty. Complete details of the warranty applicable to this Product and its terms can be found at www.petsafe.net and/or are available by contacting your local Customer Care Center.

- Radio Systems PetSafe Europe Ltd, 2nd Floor, Elgee Building, Market Square, Dundalk, Co. Louth, Ireland
- Radio Systems Corporation, 10427 PetSafe Way, Knoxville, TN 37932 USA

Australia/New Zealand – In compliance with the Australian Consumer Law, Warranties Against Defects, effective January 1, 2012, warranty details of this Product are as follows:

One Year Non-Transferrable Limited Warranty

What is covered: Radio Systems Australia Pty Ltd. (hereinafter referred to as “Radio Systems”) warrants to the original retail purchaser, and not any other purchaser or subsequent owner, that its Product, when subject to normal and proper residential use, will be free from defects in material or workmanship for a period of one (1) year from the purchase date. An “original retail consumer purchaser” is a person or entity who originally purchases the Product, or a gift recipient of a new Product that is unopened and in its original packaging.

When serviced by Radio Systems Customer Service, Radio Systems covers labor and parts for the first year of ownership; after the first year, a service or upgrade charge will apply relative to replacement of the Product with new or refurbished items at Radio Systems' sole discretion.

The limited warranty is non-transferrable and shall automatically terminate if the original retail consumer purchaser resells the Radio Systems Product or transfers the property on which the Radio Systems Product is installed. This Limited Warranty excludes accidental damage due to dog chews; lightning damage; or neglect, alteration, and misuse. Consumers who purchase products outside of Australia, New Zealand, or from an unauthorised dealer will need to return the Product to the original place of purchase for any warranty issues.

Please note that Radio Systems does not provide refunds, replacements, or upgrades for change of mind, or for any other reason outside of these Warranty terms.

Claims Procedure

Any claim made under this Warranty should be made directly to Radio Systems Australia Pty Ltd. Customer Care Centre at:

Radio Systems Australia Pty Ltd.
PO Box 765, Mudgeeraba QLD 4213
Australia Residents: 1800 786 608
New Zealand Residents: 0800 543 054
Email: info@petsafeaustralia.com.au

To file a claim, a proof of purchase must be provided. Without a proof of purchase, Radio Systems will not repair or replace faulty components. Radio Systems requests the Consumer to contact the Radio Systems Customer Care Centre to obtain a Warranty Return number, prior to sending the Product. Failure to do so may delay in the repair or replacement of the Product.

If the Product is deemed to be faulty within 30 days from date of original purchase, Radio Systems will organise for a replacement to be sent in advance of returning the faulty Product. A Post Bag will be included with the replacement Product for the return of the faulty Product. The Product must be returned within 7 days of receiving the replacement. If the Product is deemed to be faulty after 30 days from the date of original purchase, the consumer will be required to return the Product to Radio Systems at the consumer's own expense. Radio Systems will test and replace the faulty unit or its components and return to the consumer free of charge, provided the Product is within its said warranty period. This warranty is in addition to other rights and remedies available to you under the law. Radio Systems goods come with guarantees that cannot be excluded under the Australia Consumer Law. You are entitled to a replacement or refund for a major failure and for compensation for any other reasonably foreseeable loss or damage. You are also entitled to have the goods repaired or replaced if the goods fail to be of acceptable quality and the failure does not amount to a major failure.

Should you have any queries or require any further information, please contact our Customer Care Centre on 1800 786 608 (Australia) or 0800 543 054 (New Zealand).

Protected by patents: US8069823, AUS2008203914, AUS2008348347, CAN2676885, CAN2712223, NZ578757. Other patents pending. Other patents pending.

Radio Systems® Corporation
10427 PetSafe Way
Knoxville, TN 37932
1-800-732-2677
www.petsafe.net
400-1818

©2014 Radio Systems Corporation