

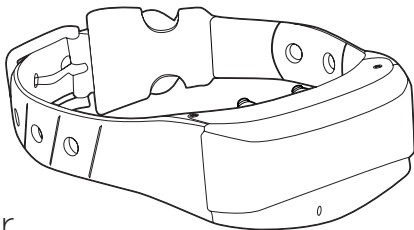

protect. **teach.** **love.**

Model Number  
PIG00-13620

ultrasmart<sup>®</sup>  
receiver collar  
operating guide



PLEASE READ THIS ENTIRE GUIDE BEFORE BEGINNING

# Important Safety Information

## Explanation of Attention Words and Symbols used in this guide



This is the safety alert symbol. It is used to alert you to potential personal injury hazards. Obey all safety messages that follow this symbol to avoid possible injury or death.

### **⚠ WARNING**

WARNING indicates a hazardous situation which, if not avoided, could result in death or serious injury.

### **CAUTION**

CAUTION, used without the safety alert symbol, indicates a hazardous situation which, if not avoided, could result in harm to your pet.

### **NOTICE**

NOTICE is used to address safe use practices not related to personal injury.

---

### **⚠ WARNING**

Not for use with aggressive dogs. Do not use this product if your dog is prone to aggressive behavior. Aggressive dogs can cause severe injury or death to their owners and others. If you are not sure that this product is right for your dog, please talk to your veterinarian or a certified trainer.

## **CAUTION**

This PetSafe® In-Ground Fence™ is NOT a solid barrier. The system is designed to act as a deterrent to remind pets by Static Correction to remain in the boundary established. It is important that you reinforce training with your pet on a regular basis. Since the tolerance level to Static Correction varies from pet to pet, Radio Systems® Corporation CANNOT guarantee that the system will, in all cases, keep a pet within the established boundary. Not all pets can be trained to avoid crossing the boundary! Therefore, if you have reason to believe that your pet may pose a danger to others or harm himself if he is not kept from crossing the boundaries, you should NOT rely solely upon the PetSafe® In-Ground Fence™ to confine your pet. Radio Systems® Corporation shall NOT be liable for any property damage, economic loss or any consequential damages, sustained as a result of any animal crossing the boundary.

Proper fit of the collar is important. A collar worn for too long or made too tight on the pet's neck may cause skin damage. Ranging from redness to pressure ulcers; this condition is commonly known as bed sores.

- Avoid leaving the collar on the dog for more than 12 hours per day.
- When possible reposition the collar on the pet's neck every 1 to 2 hours.

## **CAUTION**

- Check the fit to prevent excessive pressure; follow the instructions in this manual.
- Never connect a lead to the electronic collar; it will cause excessive pressure on the contacts.
- When using a separate collar for a lead, don't put pressure on the electronic collar.
- Wash the dog's neck area and the contacts of the collar weekly with a damp cloth.
- Examine the contact area daily for signs of a rash or a sore.
- If a rash or sore is found, discontinue use of the collar until the skin has healed.
- If the condition persists beyond 48 hours, see your veterinarian.
- For additional information on bed sores and pressure necrosis, please visit our website.

These steps will help keep your pet safe and comfortable. Millions of pets are comfortable while they wear stainless steel contacts. Some pets are sensitive to contact pressure. You may find after some time that your pet is very tolerant of the collar. If so, you may relax some of these precautions. It is important to continue daily checks of the contact area. If redness or sores are found, discontinue use until the skin has fully healed.

You may need to trim the hair in the area of the Contact Points. Never shave the dog's neck; this may lead to a rash or infection.

To prevent an unintended correction:

- The Receiver Collar should not be on your dog when the system is tested.
- Remove the Receiver Collar before making any changes to your system.
- Before placing the Receiver Collar on your pet, test the boundary location and width after any change.
- Do not charge your Receiver Collar every night. Charging too often can reduce battery life. Charge your Receiver Collar when the left Receiver Indicator Light blinks yellow; or when the light blinks red.

#### **NOTICE**

Thank you for choosing PetSafe®, the best selling brand of electronic training solutions in the world. Our mission is to be the most trusted brand in the pet ownership experience. We want to ensure your pet's safety by providing you with the tools and techniques to successfully train your pet. If you have any questions, please contact the Customer Care Center at 1-800-732-2677 or visit our website at [www.petsafe.net](http://www.petsafe.net).

To get the most protection out of your warranty, please register your product within 30 days at [www.petsafe.net](http://www.petsafe.net). By registering and keeping your receipt, you will enjoy the product's full warranty and should you ever need to call the Customer Care Center, we will be able to help you faster. Most importantly, PetSafe® will never give or sell your valuable information to anyone. Complete warranty information is available online at [www.petsafe.net](http://www.petsafe.net).

# How the System Works

A radio signal is sent by the transmitter of your UltraSmart® In-Ground Fence™ to a receiver located on your dog's collar. The signal is transmitted through a wire which is placed along the boundaries you want to establish. The wire is an antenna that carries the signal. The receiver, attached to your dog's collar, provides a warning beep when he approaches the wire. If your pet continues into the Static Correction Zone, a safe Static Correction will be delivered through the Contact Points to get his attention until he returns to the Pet Area. Although harmless, this will discourage him from continuing further. Three adjustable levels of correction allow you to choose the one that is appropriate for your dog's temperament. The PetSafe® UltraSmart® In-Ground Fence™ has been proven safe, comfortable and effective for dogs over 8 pounds.

---

## Prepare the Receiver Collar

Your Receiver Collar comes with short Contact Points installed. Use the long Contact Points for pets with long or thick hair. Tighten the Contact Points using the Contact Point Wrench included in your In-Ground Fence™ (A). Check the tightness weekly.

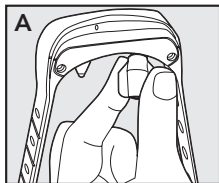

# Charge the Receiver Collar

Before you can begin using the Receiver Collar, you will need to charge it for 2-3 hours using the Receiver Collar Charger included with the UltraSmart® In-Ground Fence™. Additional Receiver Collar Chargers (part #IUA-005) can also be purchased from the Customer Care Center. The Receiver Collar fits on top of the charger with the Contact Points facing down through the holes (B). The Receiver Collar light will glow red when the collar is properly seated and charging. The light will turn green when charging is complete. A built in safety circuit prevents the Receiver Collar from overcharging.

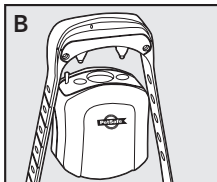

The Receiver Collar will achieve a full charge in 2-3 hours. Each charge can last up to three months depending on frequency of use.

## NOTICE

Do not charge your Receiver Collar every night. Frequent charging can have a negative effect on the battery. We recommend that the Receiver Collar be used until the Receiver Indicator Light blinks yellow or red.

The Fence Transmitter includes a Collar Charge Reminder Switch that you can set to alert you when it is time to charge your dog's Receiver Collar. The "A" Setting will alert after 60 days and the "B" setting will alert after 30 days.



To set the reminder, turn the switch to the OFF position, then move to either the A or B setting. After the 30 or 60 days has passed, the Fence Transmitter will sound three short reminder tones every minute. To reset the switch, turn it to the OFF position and move back to either setting A or B, or you can choose to turn the switch OFF to disable this feature.

---

## ReadyTest® Feature

ReadyTest® gives you added confidence that the Receiver Collar is working and ready to use. When you remove the Receiver Collar from the charger, the receiver will automatically go into self-test mode for approximately 8 seconds. The receiver's internal diagnostics will check that the battery charge is full and that all circuits are working correctly. **Do not touch the Contact Points while the receiver is in test mode.** When the collar is removed from the charger, the indicator light will go off and then come back on. The light will first glow red for three seconds, then go off. The indicator light will come back on for five seconds to indicate the status of the battery (green, yellow or red). The ReadyTest® is complete once you see the battery indicator status.

If the Receiver Collar beeps and the indicator light glows solid red for 20 seconds, the ReadyTest® self-test has failed. Replace the Receiver Collar in the charger for 5 seconds and then remove. Do not touch the Contact Points. If the Receiver Collar continues to fail the ReadyTest®, call the Customer Care Center.

## **PerfectFit™ Test for Collar Fit**

This test is an added feature to verify fit but is not required for the system to function. After the ReadyTest®, the Receiver Collar will go into PerfectFit™ test mode. This mode begins with a flashing yellow light. To use this feature, you must place the Receiver Collar on your dog within 90 seconds of removing it from the Collar Charger. The Receiver Collar will emit a chime tone as the Contact Points touch your dog's skin. You will know you have the proper fit when the collar chimes and flashes green 5 consecutive times. After 90 seconds, the Receiver Collar moves into normal operation mode.

The Receiver Collar will still function normally if you are unable to place the Receiver Collar on your dog within 90 seconds of removing it from the Collar Charger. If you wish to use the PerfectFit™ test after 90 seconds have passed, place the Receiver Collar back on the charger for 5 seconds. Remove the collar and allow it to complete the ReadyTest® before placing it on your dog.

## **Receiver Collar Status Indicators**

The Receiver Collar Status Indicator Light along with the Receiver Collar Alarm Tone are used to determine the operational mode, the battery status, and the correction type. Refer to the Receiver Collar Status Indicator Table to understand the status lights and tones for the Receiver Collar. During normal operation, the Receiver Collar Indicator Light will flash every 3 seconds to indicate the battery status as shown in the table that follows.

| Status Light   | Alarm Tone | Condition   |
|--|------------|---|
| <b>While on Charger</b>  |            |   |
| Solid Red  | No Tone    | Charge in progress  |
| Solid Green  | No Tone    | Charge complete   |
| No Light   |            | Charge failure, contact Customer Care Center                              |
| <b>After Removing From Charger ReadyTest® &amp; PerfectFit™ Test</b> |            |   |
| Off (1 second) followed by Red (3 seconds)                           | No Tone    | Unit is performing ReadyTest®   |
| Continuous Green/ Yellow/Red (5 seconds)                             | No Tone    | Battery Charge Indicator  |
| Continuous Red   | 20 sec.    | ReadyTest® failure; unit is not operational, contact Customer Care Center |
| Flashing Yellow (every 1 second)                                     | No Tone    | Unit is in PerfectFit™ mode for 90 sec. after turning on                  |

|  |   |  |
|--|---|--|
| Flashing Green<br>(every 1 second)     | Chime; 5 consecutive chimes for confirmed fit | PerfectFit™ mode indicates collar is making true contact with dog's skin |
| Fast Pulsating Green                   | Warning Tone                                  | Warning tone   |
| Fast Pulsating Red                     | Duration of the Stimulation                   | Stimulation being delivered (up to 10 sec.)                              |
| Continuous Green (10 seconds)          | No Tone                                       | Over Correction Protection; collar locked for 10 sec.                    |
| Slow Blinking Green (every 3 seconds)  | No Tone                                       | Collar battery charge 100% - 60%   |
| Slow Blinking Yellow (every 3 seconds) | No Tone                                       | Collar battery charge 60% - 20%  |
| Slow Blinking Red (every 3 seconds)    | No Tone                                       | Collar battery charge 20% or less; charge immediately                    |

## Anti-Linger Prevention

The Anti-Linger Prevention feature keeps your dog from staying in the Warning Zone for long periods of time and draining the Receiver Collar battery. Your dog will hear a two second warning tone when he reaches the Warning Zone. If your dog does not return to the Pet Area after two seconds, he will receive a continuous Static Correction until he returns to the Pet Area.

## **Run Through Prevention**

This system includes a unique “run-through” prevention so that your dog cannot escape the Pet Area without receiving an increased level of Static Correction. The Receiver Collar automatically increases the Static Correction when your dog continues more than  $\frac{1}{3}$  of the way through the pet fencing Field Width. For example, if the signal is detected 12 feet from the wire and your dog enters the Static Correction Zone, this feature is activated when he is approximately 8 feet from the Boundary Wire. Your dog will then receive a Static Correction that is at an increased level corresponding to the Static Correction level setting on the Fence Transmitter.

---

## **Over Correction Protection**

In the unlikely event that your pet “freezes” in the Static Correction Zone, this feature limits the Static Correction duration to 10 seconds. While the system locks out further Static Correction, the green light will remain on for 10 seconds before resuming the correction with tone for another 10 seconds. This pattern will repeat for a maximum of three cycles, a duration of 60 seconds, or until the pet leaves the Static Correction Zone.

# To Set the Correction Level

**The Static Correction Level can be set to three different levels depending on the temperament of your dog:** Low, Medium, or High. The Static Correction Level is set using the Stimulation Level Switch located on the Fence Transmitter.

On each of the Stimulation Level settings, the Receiver Collar will emit a 2 second Warning Tone whenever your pet enters the Warning Zone. If your pet continues into the Static Correction Zone, he will receive a Static Correction.

---

## Fit the Receiver Collar

**Important:** The proper fit and placement of your Receiver Collar is important for effective training. The Contact Points must have direct contact with your pet's skin on the underside of his neck.

### **CAUTION**

Proper fit of the collar is important. A collar worn for too long or made too tight on the pet's neck may cause skin damage. Ranging from redness to pressure ulcers; this condition is commonly known as bed sores.

- Avoid leaving the collar on the dog for more than 12 hours per day.
- When possible reposition the collar on the pet's neck every 1 to 2 hours.

## CAUTION

- Check the fit to prevent excessive pressure; follow the instructions in this manual.
- Never connect a lead to the electronic collar; it will cause excessive pressure on the contacts.
- When using a separate collar for a lead, don't put pressure on the electronic collar.
- Wash the dog's neck area and the contacts of the collar weekly with a damp cloth.
- Examine the contact area daily for signs of a rash or a sore.
- If a rash or sore is found, discontinue use of the collar until the skin has healed.
- If the condition persists beyond 48 hours, see your veterinarian.
- For additional information on bed sores and pressure necrosis, please visit our website.

These steps will help keep your pet safe and comfortable. Millions of pets are comfortable while they wear stainless steel contacts. Some pets are sensitive to contact pressure. You may find after some time that your pet is very tolerant of the collar. If so, you may relax some of these precautions. It is important to continue daily checks of the contact area. If redness or sores are found, discontinue use until the skin has fully healed.

To assure a proper fit, please follow these steps:

1. Turn the Power OFF at the Fence Transmitter.
2. Start with your pet standing comfortably (C).
3. Place the Receiver Collar on your pet so that the "PetSafe®" logo is right side up and the receiver is directly under your pet's chin. Center the Contact Points underneath your pet's neck, touching the skin (D).

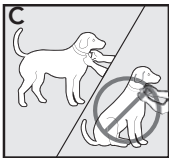

**CAUTION**

You may need to trim the hair in the area of the Contact Points. Never shave the dog's neck; this may lead to a rash or infection.

4. The PetSafe® QuickFit™ Collar is designed so you can quickly attach and remove the Receiver Collar from your pet while maintaining the desired fit.

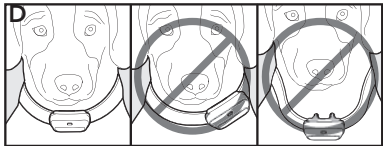

- a. With the Snap Buckle fastened (E), thread the collar through the Metal Buckle (F).
- b. Slide the excess collar through the "C" Loop on top of the Snap Buckle (G). This will hold the excess collar in place.
- c. Once the collar fit is determined, use the Snap Buckle to remove and replace the collar.



5. The Receiver Collar should fit snugly, yet loose enough to allow one finger to fit between a Contact Point and your pet's neck (**H**). Allow your pet to wear the collar for several minutes, then recheck the fit. Check the fit again as your pet becomes more comfortable with the Receiver Collar.

6. Trim the collar as follows:
- Mark the desired length of the collar with a pen. Allow for growth if your pet is young or grows a thick winter coat.

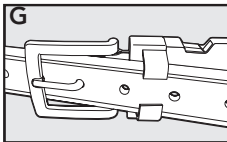
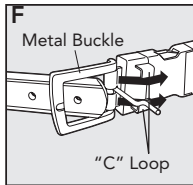
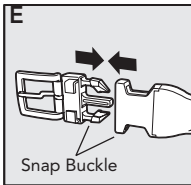

- Remove the Receiver Collar from your pet and cut off excess.

Replacement collar straps are available through the Customer Care Center.

## **Check the Fit using PerfectFit™ Test**

To check the fit of the Receiver Collar using the PerfectFit™ test, place the collar on the Collar Charger for 5 seconds. Remove the Receiver Collar and wait approximately 8 seconds for the collar to go through the ReadyTest®. Do not touch the Contact Points during the ReadyTest®. Place the collar on your pet and adjust the tightness until you hear the 5 consecutive chimes, indicating a good fit. If you do not hear the 5 consecutive chimes, tighten the metal buckle by one notch. Repeat the PerfectFit™ Test.

# Taking Your Pet Out of the Pet Area

**Important:** Remove the Receiver Collar and leave it in the Pet Area.

Once your pet learns the Boundary Zone, he will be reluctant to cross it for walks or car rides.

**Option 1:** Replace the Receiver Collar with a regular collar. Put your pet in a car that is within the Pet Area and drive him out of the Pet Area.

**Option 2:** Replace the Receiver Collar with a regular collar and leash. Walk your pet out of the Pet Area while giving a command such as "OK" at a specific place of the Boundary Zone (the end of your driveway, sidewalk, etc.). Always leave the Pet Area with a leash at this place and your pet will associate leaving the Pet Area only on a leash, only at this place, and only with a person. You may initially need to convince your pet to leave the Pet Area with a food treat and lots of praise.



*Note: You may also carry your pet out of the Pet Area.*

# Working with PetSafe® Pawz Away® Pet Barriers

Your UltraSmart® Receiver Collar also works with our Pawz Away® deterrence products to keep your pet away from areas inside or outside your home.

The Pawz Away® Indoor Pet Barrier (part number ZND-1000) protects areas inside your home and can teach your pet to stay off of furniture, away from trash or out of certain rooms. The small, battery operated Indoor Barrier fits discreetly inside your home and protects a circular area up to 12 feet in diameter. (I)

The Pawz Away® Outdoor Pet Barrier (part number RFA-378) teaches your pet to avoid areas in your landscape. The waterproof and battery operated Outdoor Barrier is disguised as a rock to blend into your landscape. It can wirelessly protect a circular area up to 16 feet in diameter or protect a custom shaped area using up to 150 feet of Boundary Wire. (J)

The Pawz Away® Pet Barrier systems are easy to operate and you can use more than one to protect multiple areas. Purchase the Pawz Away® Pet Barriers by visiting our website at [www.petsafe.net](http://www.petsafe.net) or by calling the Customer Care Center.

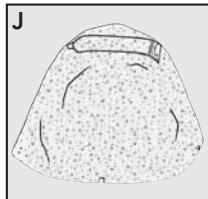
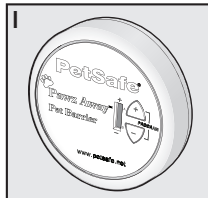

## Additional Information

- The system should only be used with healthy pets. Contact your veterinarian if you have concerns about the medical condition of your pet (medication, pregnant, heart conditions, etc.).
- The PetSafe® UltraSmart® In-Ground Fence™ is for residential use only.
- The Static Correction will get your pet's attention, but will not cause harm. It is designed to startle, not to punish.
- Test the Receiver Collar at least once a month to verify that it is functioning properly. Check that it activates at the Boundary Wire. Battery life depends upon how often the Receiver Collar is activated.
- For your pet's comfort, remove the Receiver Collar from your pet when indoors.
- Never leave the Receiver Collar on your pet for more than 12 consecutive hours.
- Consult your PetSafe® UltraSmart® In-Ground Fence™ Operating and Training Guide for additional Troubleshooting information.

# Test Light Instructions

1. Make sure the Receiver Collar battery is fully charged.
2. Hold the Test Light contacts to the Contact Points (K).
3. Hold the Receiver Collar at your dog's neck height with the Contact Points pointing up (L) and the [www.petsafe.net](http://www.petsafe.net) website on the receiver facing the Boundary Wire.
4. Slowly walk toward the Boundary Wire until you hear the warning tone (M).
5. Two seconds after the warning tone, the test light will begin to flash.

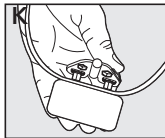

*Note: The Receiver Collar is waterproof, which can make the beep hard to hear.*

Save the Test Light for future testing.

If the Receiver Collar did not beep or the Test Light did not flash, refer to the Troubleshooting section in your PetSafe® UltraSmart® In-Ground Fence™ Operating and Training Guide or contact the Customer Care Center.

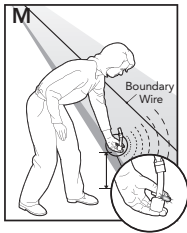
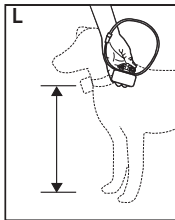

# Terms of Use and Limitation of Liability

## 1. Terms of Use

This Product is offered to you conditioned upon your acceptance without modification of the terms, conditions and notices contained herein. Usage of this Product implies acceptance of all such terms, conditions, and notices.

## 2. Proper Use

This Product is designed for use with pets where training is desired. The specific temperament of your pet may not work with this Product. We recommend that you not use this Product if your pet is less than 8 pounds or if your pet is aggressive. If you are unsure whether this is appropriate for your pet, please consult your veterinarian or certified trainer.

Proper use includes reviewing the entire Guide provided with your Product and any specific Caution statements.

## 3. No Unlawful or Prohibited Use

This Product is designed for use with pets only. This pet training device is not intended to harm, injure or provoke. Using this Product in a way that is not intended could result in violation of Federal, State or local laws.

#### **4. Limitation of Liability**

In no event shall Radio Systems Corporation® be liable for any direct, indirect, punitive, incidental, special or consequential damages, or any damages whatsoever arising out of or connected with the use or misuse of this Product. Buyer assumes all risks and liability from the use of this Product.

#### **5. Modification of Terms and Conditions**

Radio Systems Corporation® reserves the right to change the terms, conditions and notices under which this Product is offered.

---

## **Compliance**

### **FCC/Canada**

This Class B digital apparatus complies with Canadian ICES-003. This equipment has been tested and found to comply with the limits for a Class B digital device, pursuant to Part 15 of the FCC Rules. These limits are designed to provide reasonable protection against harmful interference when the equipment is operated in a residential environment. This equipment generates, uses, and can radiate radio frequency energy and, if not installed and used in accordance with the instruction guide, may cause harmful interference to radio communications. However, there is no



guarantee that interference will not occur in a practical installation. If this equipment causes harmful interference to radio or television reception, which can be determined by turning the equipment off and on, the user is encouraged to try to correct the interference by one or more of the following measures:

- Relocate the interfered receiving antenna.
- Increase the separation between the equipment and receiver.
- Connect the equipment into an outlet on a circuit different to that to which the receiver is connected.
- Contact the Customer Care Center.

This device complies with Industry Canada Rules. This device complies with part 15 of the FCC Rules. Operation is subject to the following two conditions: (1) This device may not cause harmful interference, and (2) this device must accept any interference received, including interference that may cause undesired operation.

Unauthorized changes or modifications to the equipment, not approved by Radio Systems Corporation®, could result in not meeting compliance with FCC regulations and could void the user's authority to operate the equipment.

# Australia

This device complies with the applicable EMC requirements specified by the ACMA (Australian Communications and Media Authority).

---

## Customer Care International

Canada - Tel: 800-732-2677

Monday - Friday 8 AM - 8 PM / Saturday 9 AM – 5 PM

Australia - Tel: 1800 786 608

Monday - Friday 7:30 AM - 5 PM

New Zealand - Tel: 0800 543 054

Monday - Friday 10:30 AM - 7 PM

This product has the benefit of a limited manufacturer's warranty. Details of the warranty applicable to this product and its terms can be found at [www.petsafe.net](http://www.petsafe.net) and/or are available by sending a stamped addressed envelope to PetSafe® Ltd. Redthorn House, Unit 9, Chorley West Business Park, Ackhurst Road, Chorley, Lancashire PR7 1NL, United Kingdom.



Radio Systems® Corporation  
10427 PetSafe Way  
Knoxville, TN 37932  
1-800-732-2677  
[www.petsafe.net](http://www.petsafe.net)  
400-1428

Covered by US Patents 6,184,790; 6,327,999; 6,459,378; 6,807,720;  
7,046,152; 7,068,174; 7,117,822; 7,204,204; 7,278,376; 7,345,588; 7,394,390;  
7,404,379; 7,426,906; 7,495,570; 7,574,979; 7,667,607; D522,187; D523,998.

©2009 Radio Systems Corporation